

# VARI®

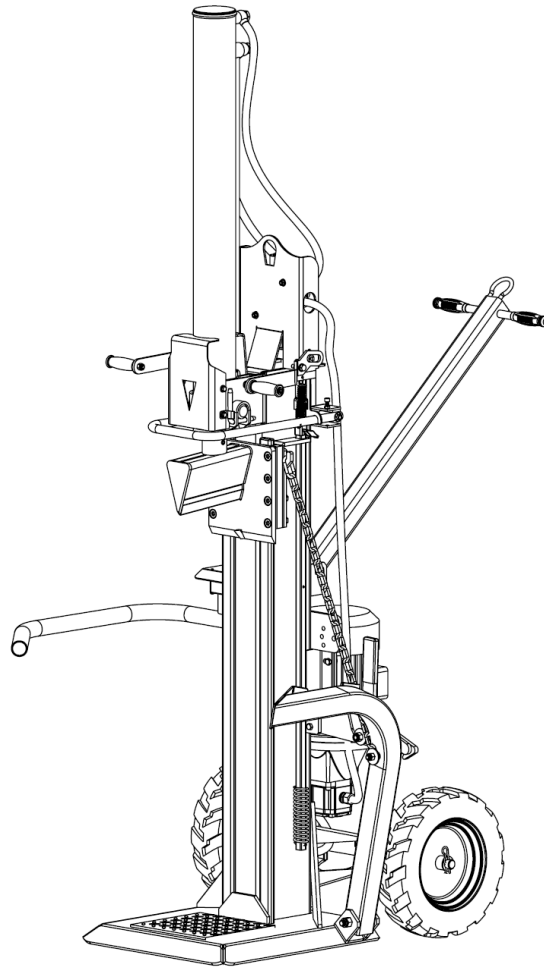

## FOR YOUR SAFETY

**READ AND UNDERSTAND THE ENTIRE MANUAL  
BEFORE OPERATING THE MACHINE**

MODEL: VARI 16 TON SUPER FORCE  
SERIAL NUMBER:

Both model number and serial number may be found on the main label.  
You should record both of them in a safe place for future use.

**Save This Manual for Future Reference**

**HYDRAULIC LOG SPLITTER**  
Instructions for use (Original instructions for use) 2013

## TABLE OF CONTENTS

INTRODUCTION .....	2
ENVIRONMENT .....	2
SYMBOLS .....	3
SAFETY .....	4
SPECIFICATIONS .....	7
APPLICATION CONDITIONS .....	7
ELECTRICAL REQUIREMENTS .....	8
CONTENTS SUPPLIED .....	8
ASSEMBLY .....	9
DELIVERING LOG SPLITTER TO WORK SITE .....	13
SPLITTER OPERATION .....	13
FREE A JAMMED LOG .....	18
REPLACING OIL .....	18
SHARPENING WEDGE .....	19
TROUBLESHOOTING .....	20
WIRING DIAGRAM          PLUMBING DIAGRAM .....	20
PART LIST .....	21
DISPOSAL OF PACKAGING AND MACHINE AFTER THE END OF SERVICE LIFE .....	23
INSTRUCTIONS FOR ORDERING SPARE PARTS .....	23
ADDRESS OF THE MANUFACTURER .....	24
ADDRESS OF THE IMPORTER AND DISTRIBUTOR .....	24
LETTER OF GUARANTEE .....	26

*Edition 2013. The manufacturer reserves the right to introduce technical modifications and innovations, which do not affect the function and safety of the machine. These modifications may not necessarily be specified in this user manual. Printing errors reserved.*

## INTRODUCTION

Your new log splitter will more than satisfy your expectations. It has been manufactured under stringent quality standards to meet superior performance criteria. You will find your new unit easy and safe to operate, and with proper care, it will give you many years of dependable service.



Carefully read through this entire operator's manual before using your new log splitter. Take special care to heed the cautions and warnings.

## ENVIRONMENT



Recycle unwanted materials instead of disposing of them as waste. All tools, hoses and packaging should be resorted, taken to the local recycling centre and disposed of in an environmentally safe way.

## SYMBOLS

The rating plate on your machine may show symbols. These represent important information about the product or instructions on its use.



Read these instructions in full before using the machine.



Keep your work space tidy!  
Untidiness may result in accidents.



Do not remove or tamper with any protection or safety devices.



Wear safety footwear



Wear safety gloves



Wear eye protection.  
Wear hearing protection.



Do not smoke or have open flames.



Keep bystanders away from the working area.



Avoid injury from the movement of the splitting blade.



Always keep hands out of the path of all moving parts.



Do not remove jammed logs with your hands.



Before starting any repairs, maintenance or cleaning, always disconnect the power.



Dispose of the used oil in an environment-friendly way.



Caution! Thrown objects.

## **SAFETY**

### **SAFETY WARNINGS & INSTRUCTIONS**

#### **• UNDERSTAND YOUR LOG SPLITTER**

Read and understand the owner's manual and labels affixed to the log splitter. Learn its application and limitations as well as the specific potential hazards peculiar to it. Be thoroughly familiar with the controls and their proper operation.

#### **• DRUGS, ALCOHOL AND MEDICATION**

Do not operate the log splitter while under the influence of drugs, alcohol or any medication that could affect your ability to use it properly.

- **AVOID DANGEROUS CONDITIONS**

Always operate your log splitter on dry, solid, level ground. Never operate your log splitter on slippery, wet, muddy or icy surfaces. The location you choose should be free from any tall grass, brush or other interferences. There should be plenty of room for handling, and help the operator stay alert. Keep your work area clean and well lighted. Cluttered areas invite injuries. To avoid tripping, do not leave tools, logs or other components lying around the work area. Do not use the log splitter in wet or damp areas or expose it to rain. Do not use it in areas where fumes from paint, solvents or flammable liquids pose a potential hazard.

- **INSPECT YOUR LOG SPLITTER**

Check your log splitter before turning it on. Keep guards in place and in working order. Form a habit of checking to see that keys and adjusting wrenches are removed from tool area before turning it on. Replace damaged, missing or failed parts before using it. Make sure all nuts, bolts, screws, hydraulic fittings, hose clamps, etc. are securely tightened. Always check the oil level in the hydraulic oil tank. Never operate your log splitter when it is in need of repair or is in poor mechanical condition. Before starting work, test the stopping devices to keep them in safe working condition.

- **DRESS PROPERLY**

Do not wear loose clothing, gloves, neckties or jewellery (rings, wrist watches). They can be caught in moving parts. Protective, electrically non-conductive gloves, non-skid footwear and hearing protection are recommended when working. Wear protective hair covering to contain long hair, preventing it from get caught in machinery.

- **PROTECT YOUR EYES AND FACE**

Any log splitter may throw foreign objects into the eyes. This can cause permanent eye damage. Always wear safety goggles. Everyday eyeglasses have only impact resistant lenses. They are not safety glasses.

- **EXTENSION CORDS**

Improper use of extension cords may cause inefficient operation of the log splitter, which can result in overheating. Be sure the extension cord is not longer than 10 m and its section is not less than 2.5 mm<sup>2</sup> to allow sufficient current flow to the motor. Avoid use of free and inadequately insulated connections. Connections must be made with protected material suitable for outdoor use.

- **AVOID ELECTRICAL SHOCK**

Check that the electric circuit is adequately protected and that it corresponds with the power, voltage and frequency of the motor. Check that there is a ground connection. Ground the log splitter. Prevent body contact with grounded surfaces: pipes, radiators, ranges, and refrigerator enclosures. Never open the switch / plug box. Should this be necessary, contact a qualified electrician. Make sure your fingers do not touch the plug's metal prongs when plugging or unplugging the log splitter.

- **PREVENT FIRES**

Do not smoke or have open flames when operating or refilling the log splitter. Never operate the log splitter near a flame or candle. Oil is flammable and can explode.

- **KEEP BYSTANDERS AWAY**

Allow only one person to load and operate the log splitter. Always keep bystanders, including visitors, children and pets away from the work area, especially when the log splitter is under operation. Only the operator should stand near the machine and only within the safe operating area prescribed in this manual. Never use another people to help you with freeing jammed log. No one under the age of 16 should be allowed to operate the log splitter. Any individual under the age of 18 should have the necessary training, skills to perform the functions properly and safely and should always be under the supervision of adult.

- **INSPECT YOUR LOG**

Never attempt to split logs containing nails, wire or debris. Always make sure that both ends of the log you are splitting are cut as square as possible. This will prevent the log from sliding out of position while under pressure. Branches must be cut off the trunk.

- **DON'T OVERREACH**

Keep proper footing and balance at all times. Never stand on log splitter. Serious injury could occur if the tool is tipped or if the cutting tool is unintentionally contacted. Do not store anything above or near the log splitter where anyone might stand on the tool to reach it.

- **AVOID INJURY FROM UNEXPECTED ACCIDENT**

Do not straddle or reach across the splitting area when operating the log splitter. Never pile logs to be split in a manner that will cause you to reach across the log splitter. Only use your hands to operate the control levers. Never use your foot, knee, a rope or any other extension device. Always pay full attention to the movement of the wedge ram. Never attempt to load your log splitter while the ram is in motion. Keep hands out of the way of all moving parts. Never try to split two logs on top of each other. One of them might fly up and hit you.

- **PROTECT YOUR HANDS**

Keep your hands away from splits and cracks which open in the log. They may close suddenly and crush or amputate your hands. Do not remove jammed logs with your hands.

- **DON'T FORCE TOOL**

It will do a better and safer job at its design rate. Don't use log splitter for a purpose for which it was not intended. Do not alter the equipment, or use the equipment in such a way as to circumvent its design capabilities and capacities. Never try to split logs larger than those indicated in the specifications table.

- **DISCONNECT POWER**

Unplug when not in use, before making adjustments, changing parts, cleaning or working on the log splitter. Consult technical manual before servicing.

- **MAINTAIN YOUR LOG SPLITTER WITH CARE**

Before cleaning, repair, inspecting or adjusting, shut off the machine and make certain all moving parts have stopped. Always clean the unit after each use. Keep the log splitter clean for best and safest performance. Follow instructions for lubricating. Inspect all hydraulic seals, hoses and couplers for leaks prior to use. Control levers and power switch must be kept clean, dry and free from oil and grease at all times.

- **PROTECT THE ENVIRONMENT**

Take used oil to an authorized collection point or follow the stipulations in the country where the log splitter is used. Do not discharge into drains, soil or water.

- **MAKE THE WORKSHOP CHILDPROOF**

Lock the shop. Store the log splitter away from children and others not qualified to use it.

- **DEAL WITH ACCIDENT**

Always have a fire extinguisher and a first aid kit available for use should the need arise. In emergency always know the location of the nearest phone or keep a phone on the job site. Also know the phone numbers of the nearest ambulance, doctor and fire department. This information will be invaluable in the case of an emergency.

## SPECIFICATIONS

<b>Model</b>		<b>65698</b>
<b>Trade Name</b>		<b>VARI 16 TON SUPER FORCE</b>
<b>Motor (400 V 3N~ 50 Hz)</b>		S6 40 % IP54 5100 W
<b>Log Size Capacity</b>	<b>Diameter</b>	32 cm
	<b>Length</b>	110 cm
<b>Maximum Force</b>		16 t
<b>Hydraulic Pressure</b>		27,7 MPa
<b>Hydraulic Oil Capacity</b>		18 l
<b>Ram Travel</b>		94,5 cm
<b>Speed</b>	<b>Forward</b>	6,7 m/min
		2,9 m/min
	<b>Retract</b>	4,7 m/min
<b>Noise Pressure Level (LpA)</b>		≤ 75 dB (A)
<b>Vibration</b>		2,5 m/s <sup>2</sup>
<b>Overall Sizes</b>	<b>Length</b>	152 cm
	<b>Width</b>	109 cm
	<b>Height</b>	252 cm
<b>Weight</b>		264 kg

## APPLICATION CONDITIONS

This log splitter is designed for operating under ambient temperatures between +5°C and +40°C and for installation at altitudes not more than 1000 m above M.S.L. The surrounding humidity should be less than 50 % at 40°C. It can be stored or transported under ambient temperatures between -25°C and +55°C.

## ELECTRICAL REQUIREMENTS

With 3 phase 400 Volt / 50Hz motor, the log splitter should be connected to standard 400V  $\pm 10\%$  / 50Hz  $\pm 1$  Hz electrical supply which has protection devices of under-voltage, over-voltage, over-current as well as a residual current device (RCD) with maximum residual current rated at 0.03 A.

The mains connection and extension cable must have 5 wires = 3P + N + PE (3/N/PE). The mains connection must have maximum 8 A fuse. Electrical connection rubber cables must comply with IEC 60245, which is always marked with symbol H07RN-F. Cables should be identified, as it is a legal requirement. The cable is not supplied with the machine.

## CONTENTS SUPPLIED

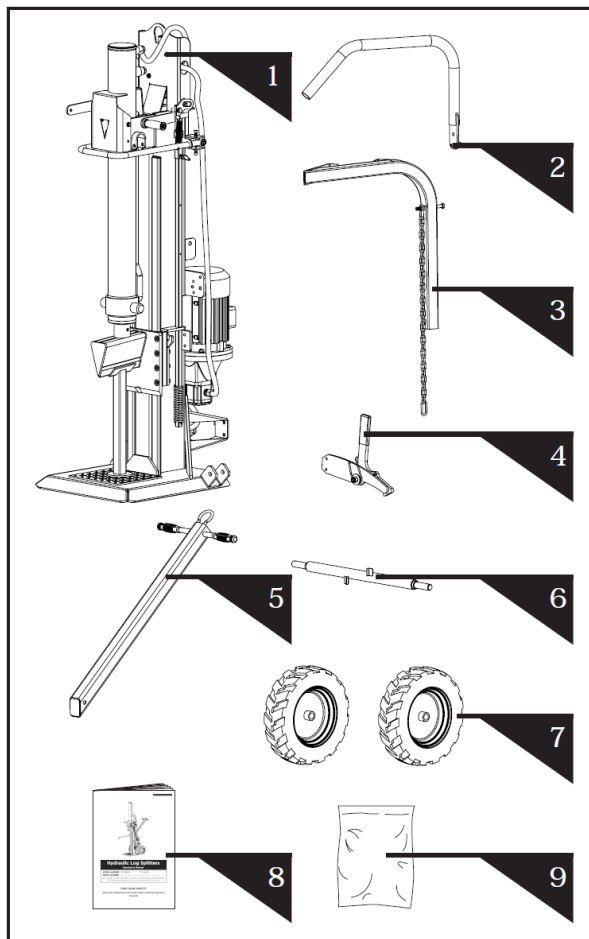

1. Log splitter frame & power station
2. Guard arm
3. Log lift
4. Retaining hook
5. Transporting handle
6. Wheel shaft
7. Wheel
8. Operator's manual
9. Hardware bag, including

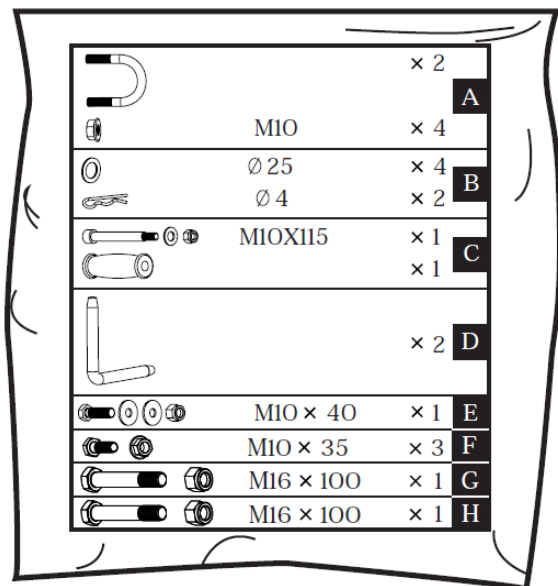



## ASSEMBLY

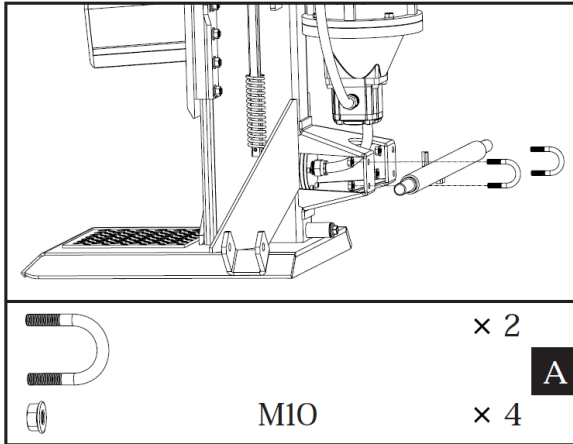

1. Attach the wheel shaft to the splitter with U-bolts and lock nuts.

2. Place a washer onto the axle, then a wheel followed by another washer, and secure with a hairpin retainer. Repeat above procedure for the other side.

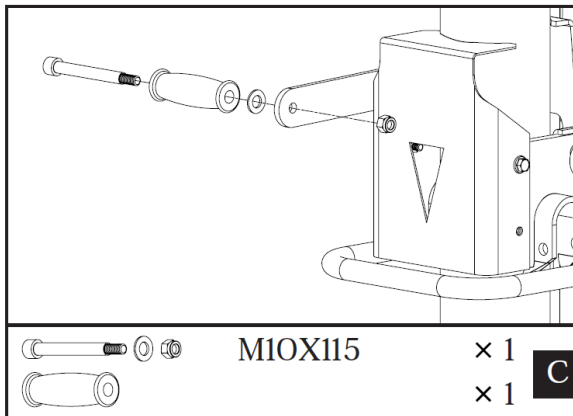
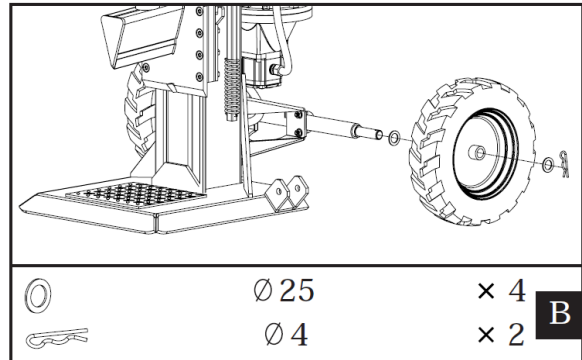

3. Install the handle to the control lever as shown.

4. Keeping the support stand against the wedge, lower both control handles to expand wedge ram. Insert the L pins to secure the cylinder to the splitter. Lock the L pins into the spring tabs.

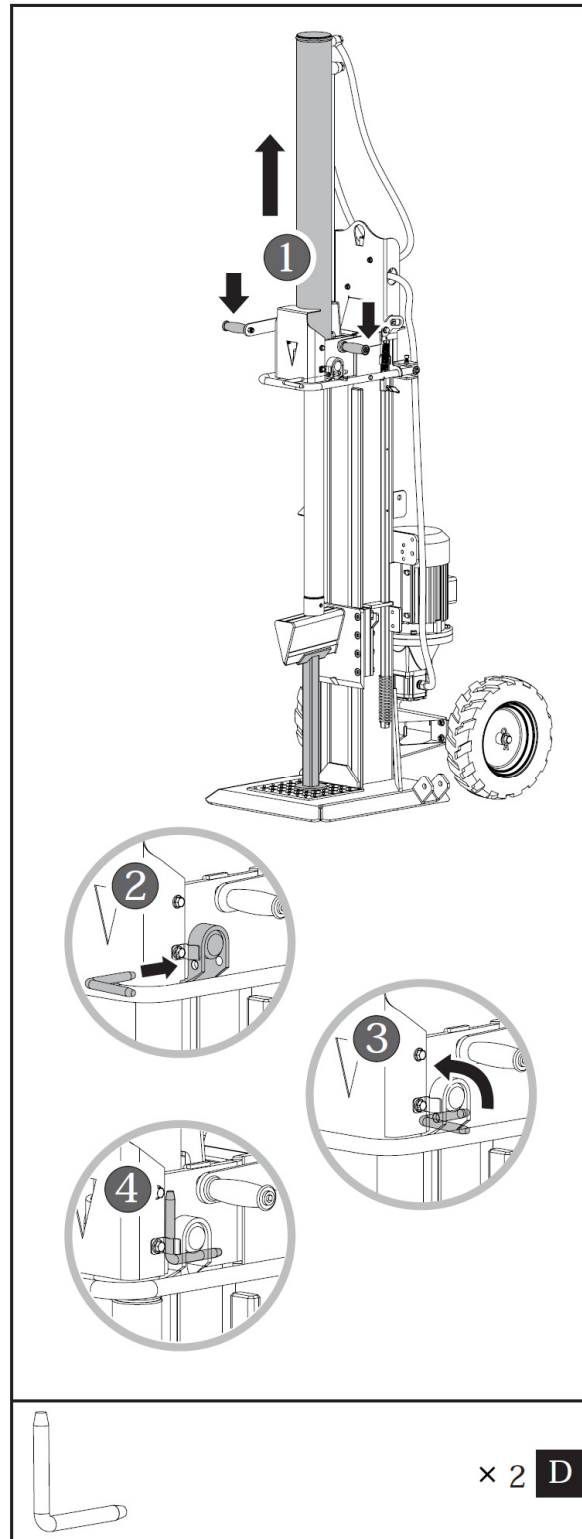

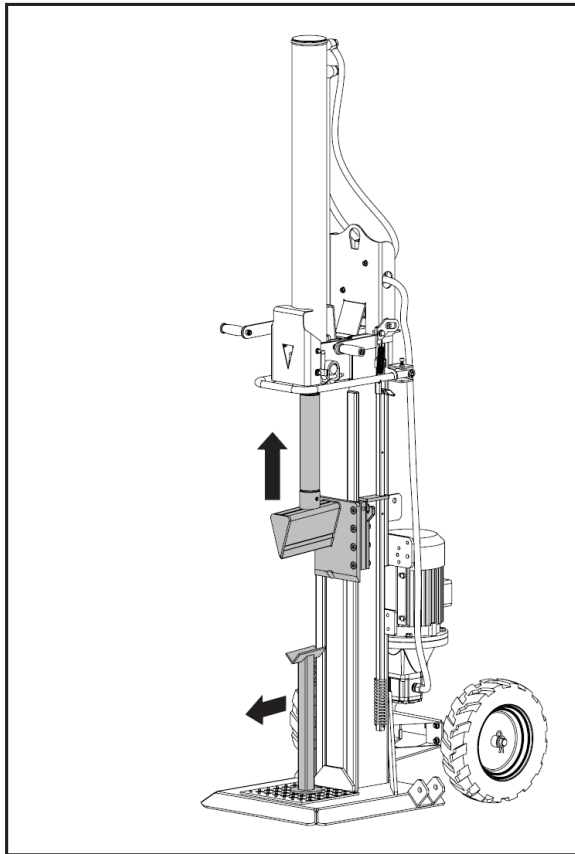

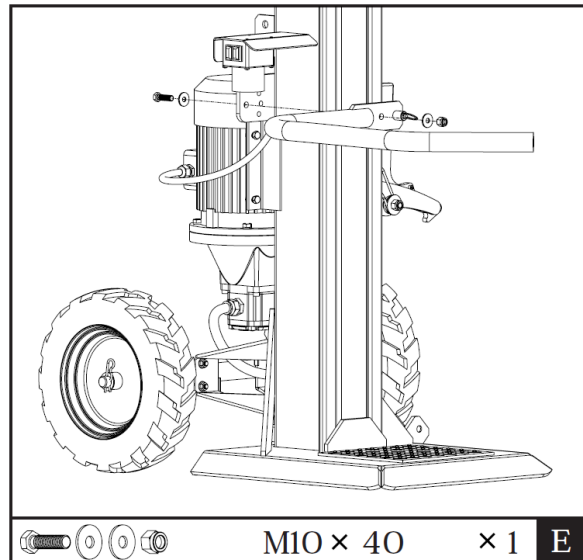

5. Release both control handles to retract the wedge ram. Remove the support stand.

6. Align the hole and locking pin of the guard arm with the mount bracket. Secure the guard arm with a M10X40 hex bolts, two washers and a nut from the hardware bag.

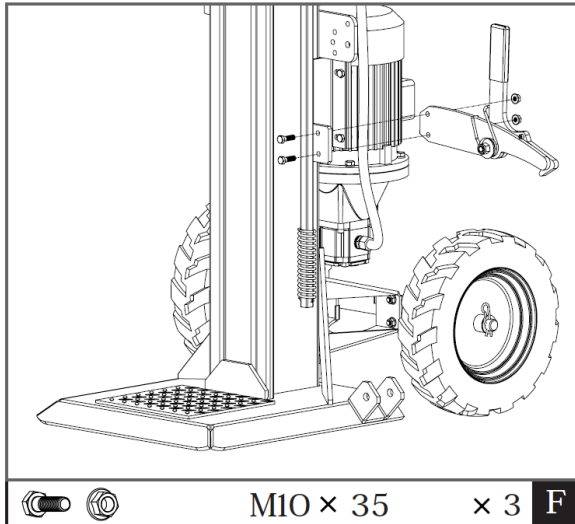



7. Position the retaining hook onto the frame and secure with two M10X35 hex bolts and nuts.

 M10 × 35 × 3 F

8. Position the log lift inside the mounting bracket and align with mounting bracket holes. Secure with a M16X100 hex bolt and nut. Hook the lift chain to wedge slide guide.

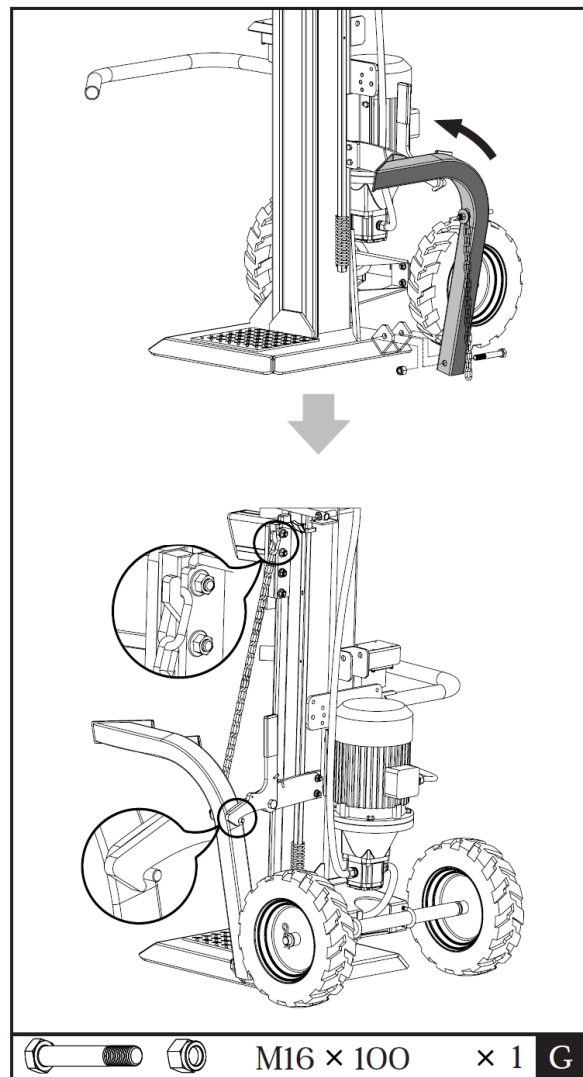

 M16 × 100 × 1 G

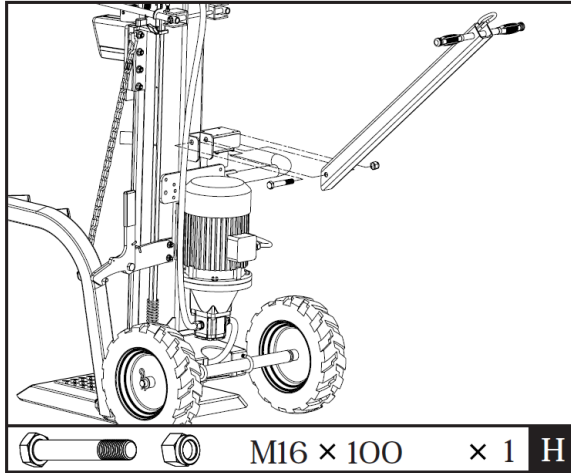

9. Place the transporting handle inside the mounting bracket. Secure with a M16X100 hex bolt and nut.

## DELIVERING LOG SPLITTER TO WORK SITE

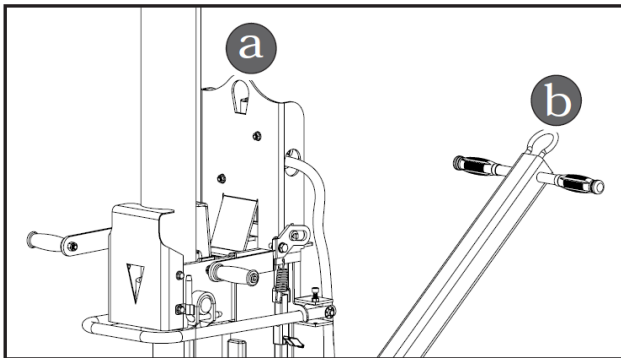

The log splitter is equipped with 2 wheels for minor moving. To move the log splitter to the work site, grip the handle (b) to tilt the log splitter slightly after making sure the oil tank cover is tightened.



**If using a crane, lay hoist sling at the lifting point (a). Never try to lift the log splitter at the Handle (b).**

## SPLITTER OPERATION

Plan your work site. Work safely and save effort by planning your work beforehand. Have your logs positioned where they can be easily reached. Have a site located to stack the split wood or load it onto a nearby truck or another carrier. Position the log splitter on solid level ground.

Apply a thin coat of grease to the surfaces of the ram before operation will lengthen the durability of the ram.

Bleed the air out of the hydraulic system before starting the log splitter. The cover of the hydraulic oil tank should be loosened by some rotations until air can go in and out of the oil tank smoothly. Air flow thru the oil tank filler should be detectable during the operations. Before moving the log splitter, make sure the cover of the oil tank is tightened to avoid oil leaking from this point.

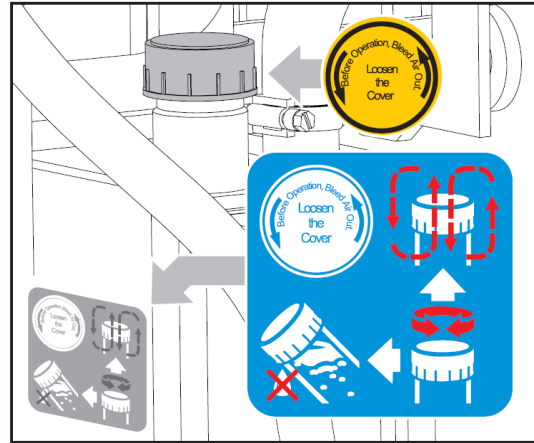

***FAILED TO LOOSEN THE OIL TANK COVER WILL KEEP THE SEALED AIR IN HYDRAULIC SYSTEM BEING COMPRESSED AFTER BEING DECOMPRESSED. SUCH CONTINUOUS AIR COMPRESSION AND DECOMPRESSION WILL BLOW OUT THE SEALS OF THE HYDRAULIC SYSTEM AND CAUSE PERMANT DAMAGE TO THE LOG SPLITTER.***

Turn the motor switch to the ON position to start the log splitter. To stop the machine, just turn the motor switch to the OFF position.

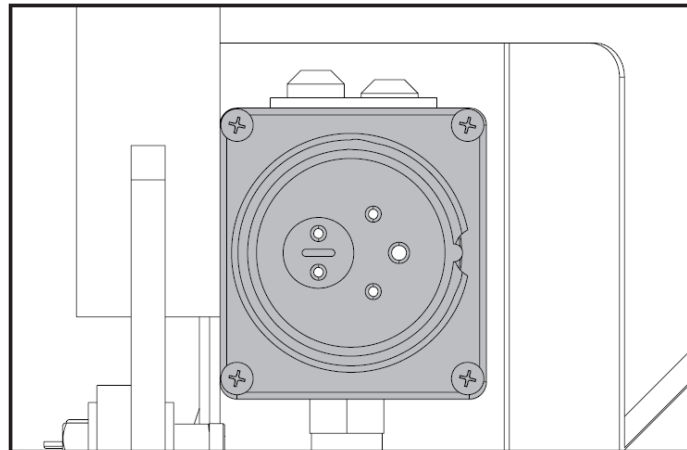

Make sure the direction of motor rotation is correct. Turn the motor on; the wedge ram should rise to the highest position automatically. If the wedge ram is already at the highest position when the motor starts, grip both control levers and lower them, the wedge ram should start to move downward.

If no ram motion is detected after the motor starts, power off the motor immediately to change motor polarity by turning the pole switching device inside the plug with a screwdriver.



400 V 3N

Never allow motor running at counter direction. This will damage the pump and will void the warranty.

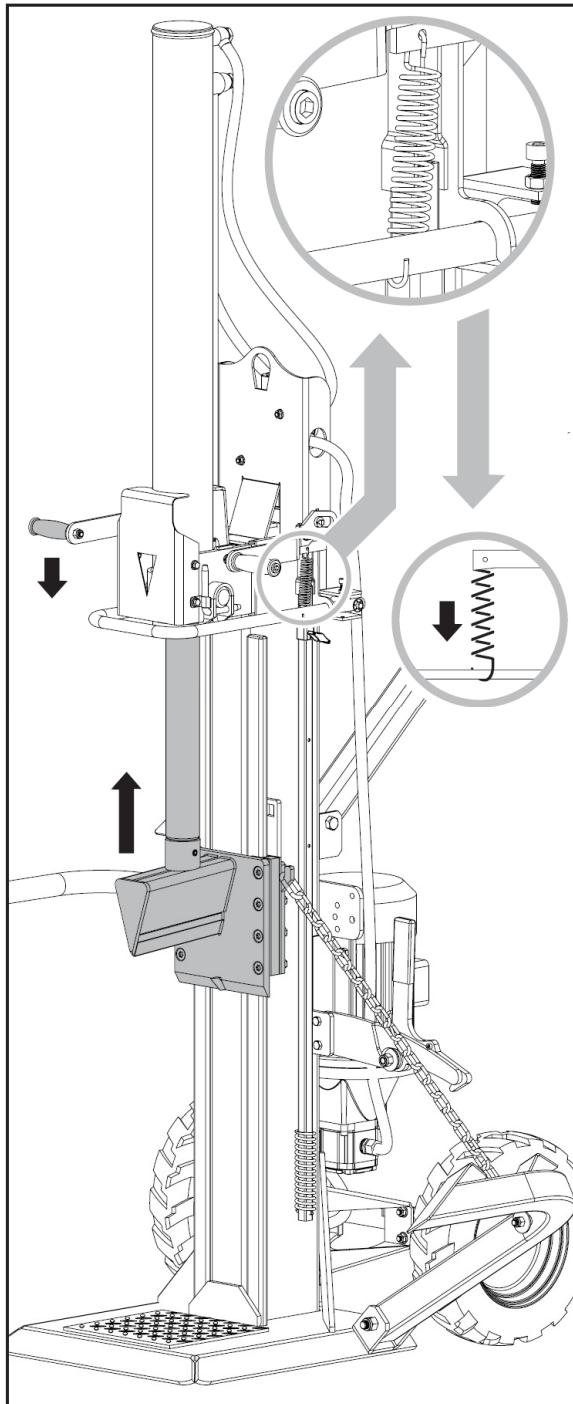

Operate the spring-loaded retract control lever to lift wedge above the height of log to be split.

To disengage the retract control lever by removing the loading spring will allow the wedge ram to retract automatically after both control handles are released.

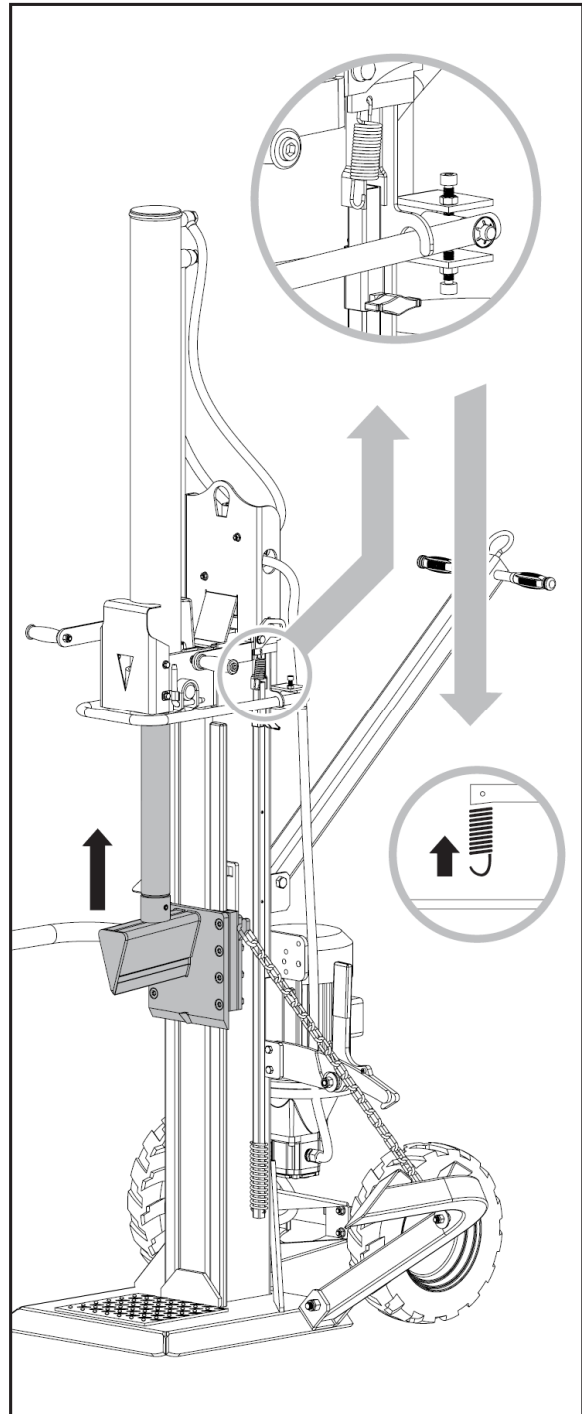



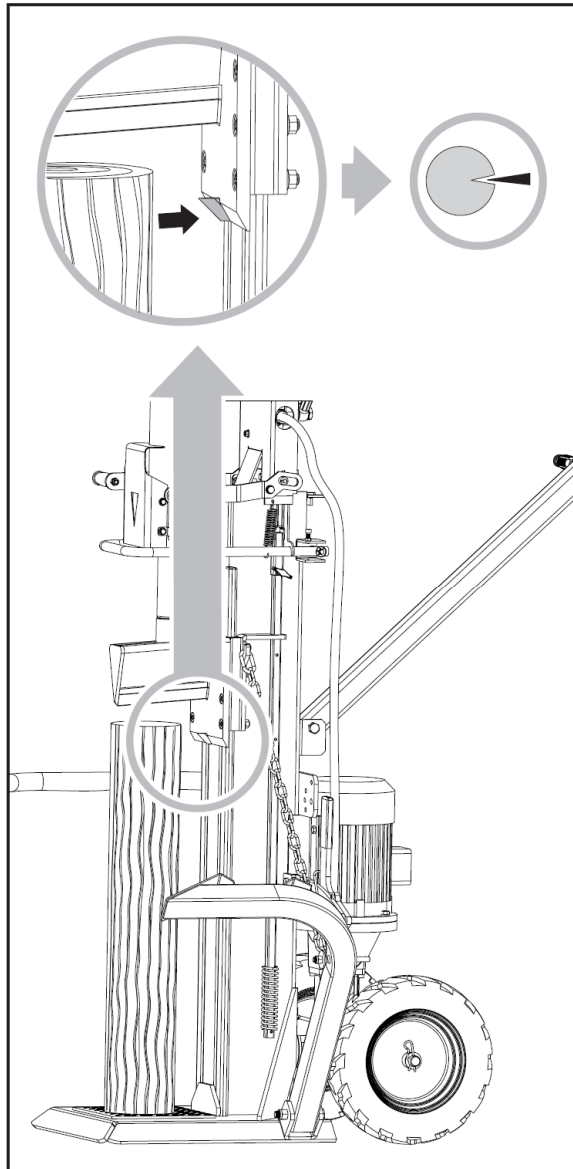

Place the log onto the support table vertically, sitting flat on the support table and push it against the hangnail to secure it. Be sure the wedge and support table will contact the log squarely on the ends. Never attempt to split a log at an angle. Lower the wedge until the log is split open.

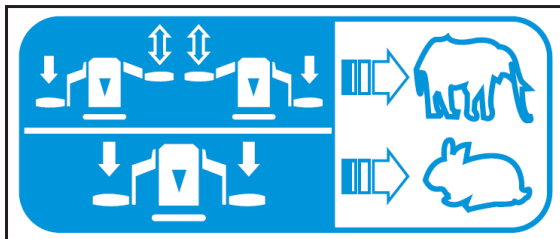

The splitting force and speed are governed by the 2-stage control handles. Lower both control handles completely for faster speed at less splitting force to split usual logs; Raise either control handle slightly for maximum splitting force at slower speed to split particularly hard and seasoned logs. These stages can be shifted by simply raising and lowering either control handle slightly.



Do not attempt to split green logs. Dry, seasoned logs split much more easily, and will not jam as frequently as green wood.



Break log in the direction of its growing grain. Do not place log across the log splitter for splitting. It may be dangerous and may seriously damage the machine.



Do not remove jammed logs with your hands. Never use another people to help you with freeing jammed log.

Stack as you work. This will provide a safer work area, by keeping it uncluttered, and avoid the danger of tripping, or damaging the power cord.



Accumulated split wood and wood chips can create a hazardous work environment. Never continue to work in a cluttered work area which may cause you to slip, trip or fall.

## **FREE A JAMMED LOG**

Do not remove jammed logs with your hands. If jammed, stop the motor and loosen the log by a downward stroke on the log with a hammer.

## **REPLACING OIL**

The hydraulic system is a closed system with oil tank, oil pump and control valve. Low oil levels can damage the oil pump.

Check oil level regularly with dipstick. The oil should be completely changed once a year.

Following hydraulic oils or equivalent are recommend for the log splitter's hydraulic transmission system:

SHELL Tellus 22

MOBIL DTE 11

ARAL Vitam GF 22

BP Energol HLP-HM 22

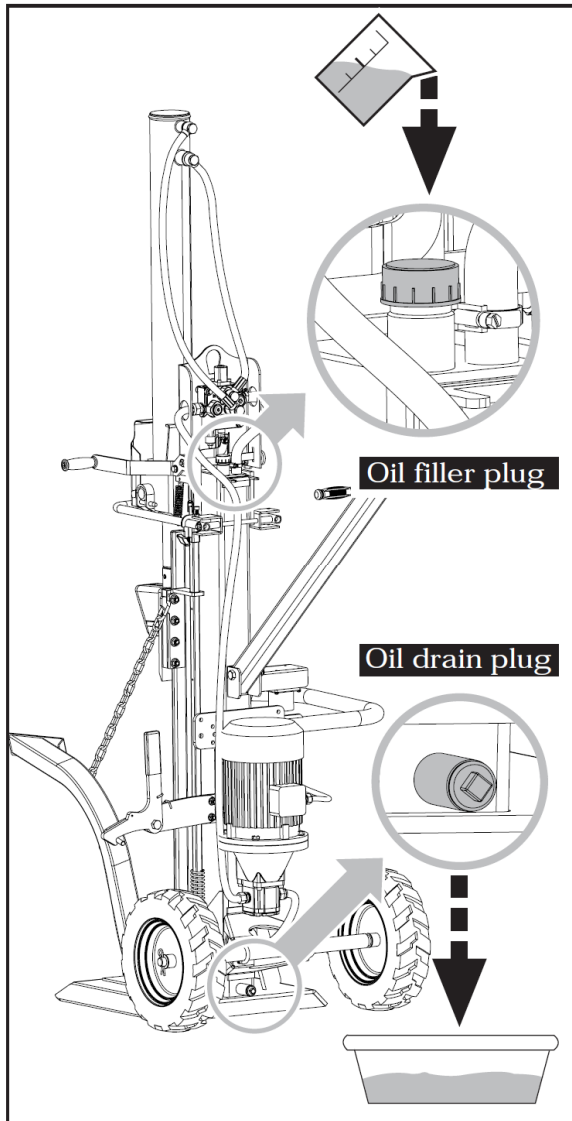

Use a drain pan to aid in the removal of all used oil and particles.

Remove oil drain plug to drain oil from the hydraulic transmission system. Examine oil for metal chips as a precaution to future problems.

After oil has been completely drained from the machine, reinstall drain plug.

Add the hydraulic transmission system with recommended oil through filler plug opening.

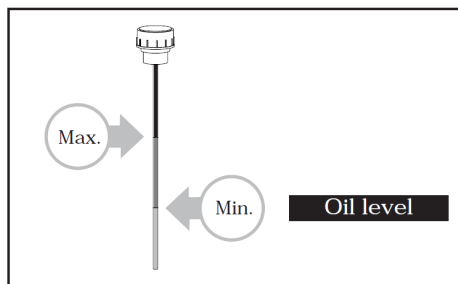

Read dipstick to determine the maximum and minimum of the oil level. Low oil can damage the oil pump. Overfilling can result in excessive temperature in the hydraulic transmission system.

Apply sealant to filler plug and reinstall it.

Following an oil change, activate the log splitter a few times without actually splitting.

## SHARPENING WEDGE

This log splitter is equipped with reinforced splitting wedge which blade is specially treated. After long periods of operation, and when required, sharpen the wedge using a fine-toothed file removing any burrs or flat spots on the edge.

## TROUBLESHOOTING

PROBLEM	PROBABLE CAUSE	REMEDY SUGGESTED
Motor does not start	Switch is OFF	ON the switch
Incorrect motor rotation direction	Incorrect connection	Change pole switching device in the plug with a screwdriver
		Reverse polarity by electrician
Log Splitter does not work while motor running	Valve is not opened owing to the connection parts loosening	Check and tighten the parts
	Control Levers or connection parts bent	Repair the bent parts
	Lower hydraulic oil level	Check and refill hydraulic oil
Log Splitter works with abnormal vibration and noise	Lower hydraulic oil level	Check and refill hydraulic oil



ATTENTION: ALL REPAIR WORK MUST BE DONE BY A SPECIALIST FOR THIS PRODUCT.

### WIRING DIAGRAM

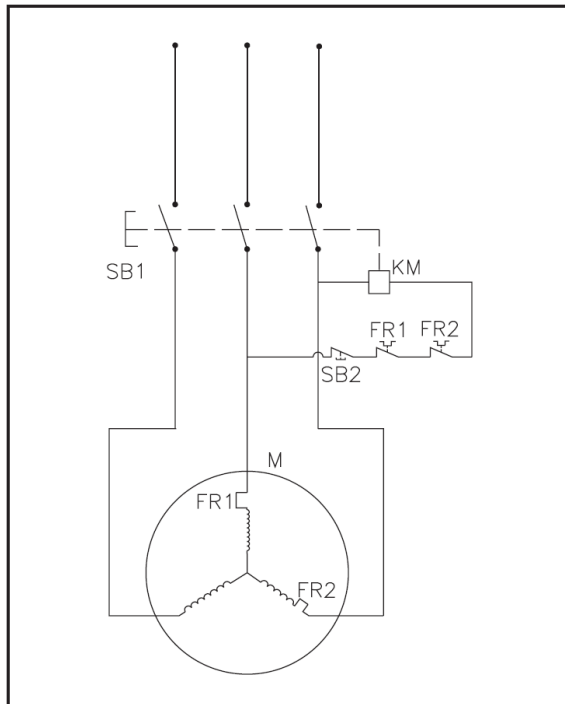

### PLUMBING DIAGRAM

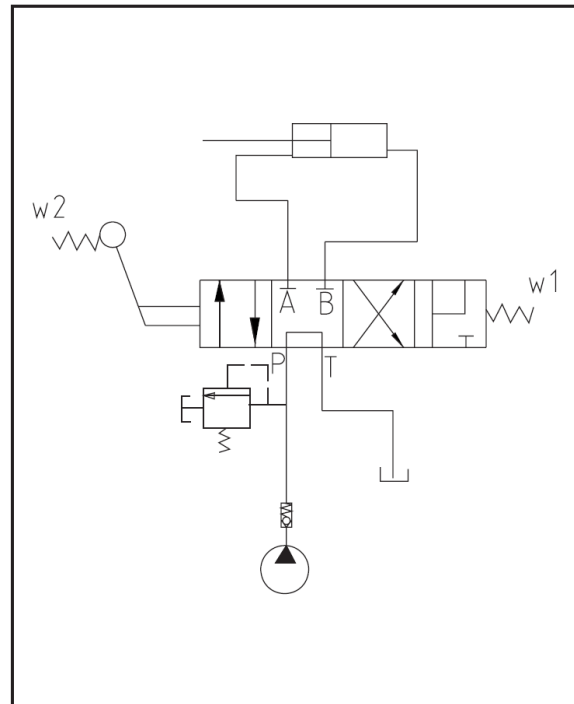

## PART LIST

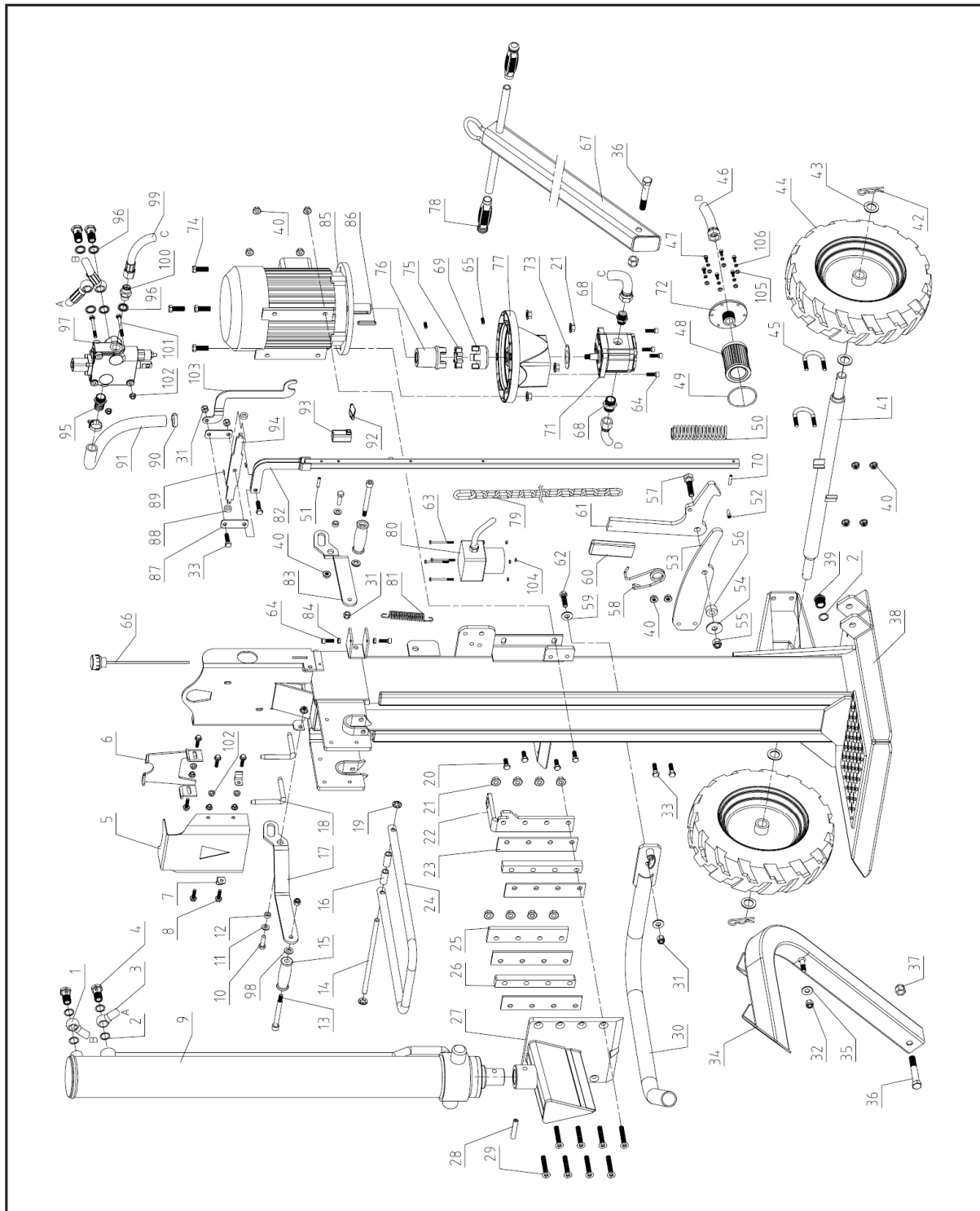

Pos.	Part No.	Name	Pcs		Pos.	Part No.	Name	Pcs
1	216001	Upper high pressure hose	1		54	216054	Washer 14	1
2	216002	Seal kit 22	5		55	216055	Nut M14	1
3	216003	Lower high pressure hose	1		56	216056	Lock spring	1
4	216004	Hose link	2		57	216057	Screw	1
5	216005	Upper guard	1		58	216058	Reset spring	1
6	216006	Lock plate	1		59	216059	Big washer 10	2
7	216007	Pin	2		60	216060	Grip	1
8	216008	Bolt M8x25	6		61	216061	Latch	1
9	216009	Cylinder	1		62	216062	Bolt M10x40	1
10	216010	Bolt M10x25	2		63	216063	Screw M4x60	4
11	216011	Washer 10	2		64	216064	Screw M8x30	8
12	216012	Sleeve 2	2		65	216065	Screw M8x15	2
13	216013	Screw	2		66	216066	Cap	1
14	216014	Lock shaft	1		67	216067	Handle lever	1
15	216015	Grip	2		68	216068	Hose fitting	2
16	216016	Sleeve	2		69	216069	Coupler 1	1
17	216017	Arm left	1		70	216070	Pin 6x45	1
18	216018	Cylinder pin	2		71	216071	Pump	1
19	216019	Spring gasket 12	2		72	216072	Flange	1
20	216020	Bolt M10x25	4		73	216073	Ring	1
21	216021	Flange nut M12	12		74	216074	Screw M12x45	4
22	216022	Plate right	1		75	216075	Coupler ring	1
23	216023	Plate middle	4		76	216076	Coupler 2	1
24	216024	Lock stop	1		77	216077	Cone frame	1
25	216025	Plate left	1		78	216078	Handle sleeve	2
26	216026	Clamp plate	2		79	216079	Chain	1
27	216027	Wedge weldment	1		80	216080	Switch	1
28	216028	Pin 12x70	1		81	216081	Spring	1
29	216029	Screw M12x70	8		82	216082	Draw bar	1
30	216030	Guard bracket left	1		83	216083	Arm right	1
31	216031	Locknut M10	5		84	216084	Nut M8	4
32	216032	Locknut M12	1		85	216085	Motor	1
33	216033	Bolt M10x35	4		86	216086	Spline	1
34	216034	Hoist guard	1		87	216087	Fitting plate	2
35	216035	Washer 12	1		88	216088	Lock plate	2
36	216036	Bolt M16x100	2		89	216089	Spring pin 3x16	2
37	216037	Nut M16	2		90	216090	Hose clamp	2
38	216038	Splitting frame weldment	1		91	216091	Oil return hose	1
39	216039	Plug M22x1,5	1		92	216092	Knob	1
40	216040	Hex bolt M10	12		93	216093	Regulating sleeve	1
41	216041	Wheel axle	1		94	216094	Binder plate	1
42	216042	Wire clip	2		95	216095	Hose fitting	1
43	216043	Washer 24	4		96	216096	Seal kit	5
44	216044	Tyre	2		97	216097	Valve	1
45	216045	Wheel axle clip	2		98	216098	Washer 12	2
46	216046	Inlet hose	1		99	216099	High pressure hose	1
47	216047	Screw M6x14	6		100	216100	Half union	1
48	216048	Oil filter	1		101	216101	Screw M8x65	2
49	216049	O-ring 75x2,65	1		102	216102	Flange nut M8	8
50	216050	Buffer spring	1		103	216103	Lock plate	1
51	216051	Pin 6x35	1		104	216104	Nut M4	4
52	216052	Screw M6x10	1		105	216105	Washer 6	6
53	216053	Lock plate	1		106	216106	Spring gasket 6	6

## DISPOSAL OF PACKAGING AND MACHINE AFTER THE END OF SERVICE LIFE

After unpacking the machine, you are obliged to provide for the disposal of packaging material with taking into account the use of secondary raw materials according to the legislation valid in your country and with respect to the decrees of local town or municipal authorities.

The following procedure is recommended for machine disposal after the end of its service life:

1. Dismount all parts from the machine that can still be used.
2. Dismount plastic machine parts and parts made of non-ferrous metals. The dismantled machine remainder and the dismantled parts are to be disposed according to the legislation valid in your country and with respect to the decrees of local town or municipal authorities.
3. Regarding waste from the electrical device, use the opportunity of **return buy-out** in the shop, where you purchased the device (**points 1 and 2 are not valid in this case**).
4. The machine is in accordance with the RoHS Directive (2002/95/EC, 2002/96/EC, 2003/108/EC).
5. The product is in accordance with the requirements of the above-mentioned EC Directive regarding the quantities of forbidden dangerous substances.



**This pictograph means that the product was introduced on the market after 13<sup>th</sup> September 2005 and shall not be disposed to a waste container or a dustbin.**



## INSTRUCTIONS FOR ORDERING SPARE PARTS

The following data are to be used for an easier identification when ordering the spare parts:

1. Machine type, engine type, machine serial number and year of manufacture;
2. Ordering number given by manufacturer and its name in the part list;
3. Number of ordered pieces separately for each item;
4. Precise address, telephone number, fax number or e-mail address;
5. Should you be uncertain about the correct identification of the component, send the damaged component either to the nearest service shop or directly to the manufacturer;
6. All components should be ordered in the nearest service shop or at your dealer's.

In the case of any confusions concerning the spare parts or technical issues, the VARI a.s. commercial, customer-service or technical departments are prepared to answer all your inquiries.

**ADDRESS OF THE MANUFACTURER**

TIYA International Co., Ltd., B12B, Shenyue Centre, 9 Shandong Road, Qingdao,  
P.R.China

**ADDRESS OF THE IMPORTER AND DISTRIBUTOR**

VARI, a.s.	phone:	(+420) 325 607 111
Opolanska 350	fax:	(+420) 325 607 264
Libice nad Cidlinou	e-mail:	<a href="mailto:vari@vari.cz">vari@vari.cz</a>
CZECH REPUBLIC	internet:	<a href="http://www.vari.cz/">http://www.vari.cz/</a>
289 07		



**EC DECLARATION OF CONFORMITY****according to Act No. 22/1997 Gaz.****(as amended)****Importer:****VARI,a.s. , Opolanská 350, 289 07 Libice nad Cidlinou, Czech Republic**

Registration No.: 00660574 , VAT No.: CZ00660574 . Registered in the Company Register at Municipal Court of Prague on 29 January 1991 Section B, Insert 499.

issue the following statement at their own responsibility:

**Description of the electrical device:**

Trade mark	Name	Type	Serial nos.
VARI	Log splitter	VARI 16 TON SUPER FORCE	000001-999999
Input	5100W/400V	Weight	264 kg
Pressure force	16 tons	Log length	up to 1100 mm

The **VARI 16 TON SUPER FORCE** (model 65698) log splitter is intended for simple splitting of wood logs. A ram pushes the log on a sharp wedge which breaks the wood log. This log splitter is intended for logs with a diameter of up to 320 mm. The machine drive is electro hydraulic.

**Regulations according to which the conformity was assessed:**NV No. 17/2003 Gaz. (2006/95/EC), NV No. 616/2006 Gaz. (2004/108/EC), NV No. 176/2008 Gaz. (2006/42/EC)  
(all Decrees of the Government /NV/ and directives as amended)**Authorized person which made the measurements:**

Jiangsu TÜV SÜD Product Service Ltd. (Shanghai branch), No. 10 Heng Tong Road, Shanghai, 200070, P. R. China

Test report: 70520113630200

Jiangsu TÜV SÜD Product Service Ltd. Beijing branch, Unit 918, Landmark Tower 2, 8 North Dongsanhuan Road, Beijing, 100004, P.R. China

Test report: 888001101001

**Authorized person which issued the certificates:**

TÜV SÜD Product Service GmbH, Ridlerstrasse 65, 80339 München, Germany

Certificates: N8M111166014012, M8A111166014013, E8N120366014018

**Harmonised technical standards and technical specifications used:**EN609-1/A2:2009, EN60204-1:2006+A1:2009, EN60034-1/A11:2002,  
EN55014-1/A1:2009, EN55014-2/A2:2008, EN61000-3-2/A2:2009, EN61000-3-11:2000**Last two digits of the year when the product was marked with CE: 11****Technical documentation file No. in which the product's compliance with the regulations is assessed: STD/011/2013**

**We declare that:** This machine, as defined with the above-mentioned data, complies with the basic requirements of the Government Decree (NV) and technical regulations and is safe under conditions of usual or by the manufacturer specified use. Furthermore precautions have been made to guarantee conformity of all products introduced on the market with the technical documentation and requirements of the technical regulations. The machine is safe under conditions of usual or specified use.

**Place of issue of the declaration of conformity: Libice nad Cidlinou      Date: 16.7.2013****Name, surname and function of the person authorized to sign this EC Declaration of Conformity:**

Jiří BELINGER, Director General (CEO) and Chairman of the Board of Directors VARI,a.s.

Signature:



Stamp:

**VARI®** - Konstrukce  
Opolanská 350  
289 07 Libice nad Cidlinou  
DIČ: CZ00660574

# LETTER OF GUARANTEE

## To be completed by importer

Name of product **Log splitter**  
 Model **VARI 16 TON SUPER FORCE**  
 Serial number .....  
 Engine serial number .....  
 Warranty (months) ..... **24** .....  
 Output control .....

The above product was passed over to the purchaser without any defects including the appropriate commercial and technical documentation and accessories. The purchaser was duly informed about the principles of sound operation and technical maintenance of the product.

## To be completed by seller

Name of purchaser .....  
 Address of purchaser .....  
 Purchaser's signature .....  
 Place of sale .....  
 Date of sale .....

Seller's stamp and signature .....

## GUARANTEE CONDITIONS

### Subject of warranty:

Warranty relates to the basic product including accessories supplied by VARI a.s.

### Warranty period:

Warranty period for the product and accessories supplied with the product is 24 months from the date of sale to the purchaser. Time from the enforcement of liability for defects to the date when the user was obliged to take over the thing after the end of repair is not included in the warranty period.

The seller is obliged to give the purchaser a receipt confirming the date of the right exercise and repair and the time of its duration. If the product is exchanged, the warranty period starts running again from the date on which the purchaser took over the new product. If it is a whole assembly to be replaced, the warranty period starts running for the given assembly again from the date of product take-over.

### Scope of manufacturer's liability:

Importer bears responsibility for the product having properties usual for the kind of the product in question and specified parameters for the whole period of warranty. The importer does not answer for defects of the product resulting from current wear or from the product's use for purposes other than specified.

### Warranty extinction:

#### Claim of warranty extincts if:

- the product was not used and maintained as specified in the Operating manual, or it was damaged by any unauthorized operation by the user;
- the product was used in conditions or for purposes other than specified;
- the letter of guarantee for the product cannot be presented;
- data filled in the original product's documentation by the manufacturer, seller or service organization were intentionally falsified;
- a part of the product was replaced with a non-original component;
- the product was damaged or excessively worn due to improper maintenance;
- the product suffered an accident or was damaged by an Act of God;
- a modification was made to the product without manufacturer's consent;
- defects result from improper storage of the product;
- defects result from natural and common operating wear of the product;
- the product was connected to or operated with the equipment not approved by the manufacturer.

### Complaints:

Complaints are applicable by purchasers at the seller's. When applying a complaint, the purchaser is obliged to submit a duly filled in letter of guarantee. Warranty repairs are carried out by sellers or by special service shops appointed by them.

### Legislation:

Other purchaser/seller relations follow appropriate provisions of the legal regulations according to national legislation in the country of sale.

<b>Warranty inspection 1</b> Date: ..... Person in charge: .....  Service shop stamp and signature	<b>Warranty inspection 1</b> Machine model..... Serial No.: .....
<b>Warranty inspection 2</b> Date: ..... Person in charge: .....  Service shop stamp and signature	<b>Warranty inspection 2</b> Machine model..... Serial No.: .....
<b>1<sup>st</sup> Warranty service</b> Date of complaint delivery: ..... Date of repair: ..... Brief description of the defect: ..... ..... Replaced parts (new warranty of ... months): ..... Parts: ..... ..... Repair made by: .....  Service shop stamp and signature	<b>1<sup>st</sup> Warranty service</b> Machine model..... Serial No.: ..... Date: ..... Repair made by: .. ..... ..... Stamp and signature: ..... ..... .....
<b>2<sup>nd</sup> Warranty service</b> Date of complaint delivery: ..... Date of repair: ..... Brief description of the defect: ..... ..... Replaced parts (new warranty of ... months): ..... Parts: ..... ..... Repair made by: .....  Service shop stamp and signature	<b>2<sup>nd</sup> Warranty service</b> Machine model..... Serial No.: ..... Date: ..... Repair made by: ..... ..... Stamp and signature: ..... ..... .....
<b>3<sup>rd</sup> Warranty service</b> Date of complaint delivery: ..... Date of repair: ..... Brief description of the defect: ..... ..... Replaced parts (new warranty of ... months): ..... Parts: ..... ..... Repair made by: .....  Service shop stamp and signature	<b>3<sup>rd</sup> Warranty service</b> Machine model..... Serial No.: ..... Date: ..... Repair made by: ..... ..... Stamp and signature: ..... ..... .....
<b>4<sup>th</sup> Warranty service</b> Date of complaint delivery: ..... Date of repair: ..... Brief description of the defect: ..... ..... Replaced parts (new warranty of ... months): ..... Parts: ..... ..... Repair made by: .....  Service shop stamp and signature	<b>4<sup>th</sup> Warranty service</b> Machine model..... Serial No.: ..... Date: ..... Repair made by: ..... ..... Stamp and signature: ..... ..... .....