

VARI®

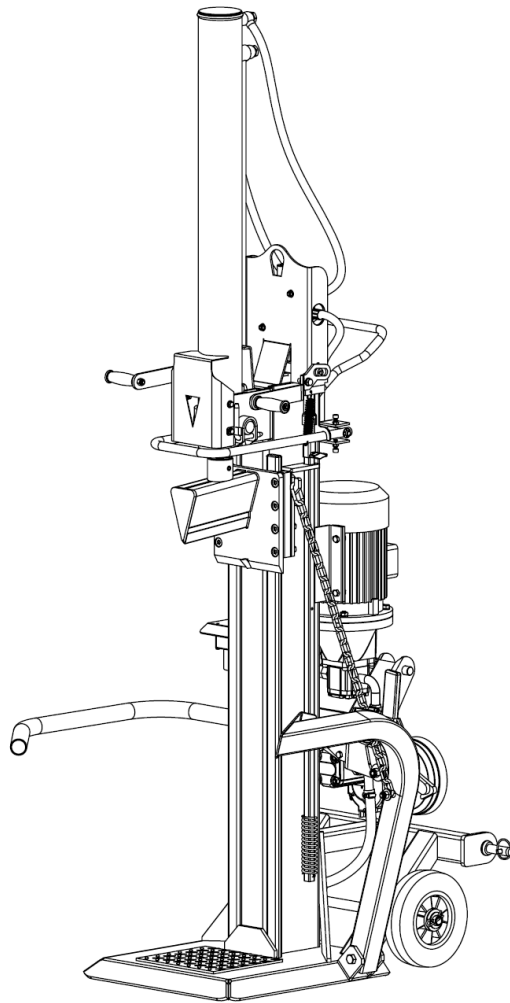

FOR YOUR SAFETY

**READ AND UNDERSTAND THE ENTIRE MANUAL
BEFORE OPERATING THE MACHINE**

**MODEL: VARI 20 TON SUPER FORCE DUO
SERIAL NUMBER:**

Both model number and serial number may be found on the main label.
You should record both of them in a safe place for future use.

Save This Manual for Future Reference

HYDRAULIC LOG SPLITTER
Instructions for use (Original instructions for use) 2013

TABLE OF CONTENTS

INTRODUCTION	2
ENVIRONMENT	2
SYMBOLS	3
SAFETY	4
SPECIFICATIONS	7
APPLICATION CONDITIONS	8
ELECTRICAL REQUIREMENTS	8
CONTENTS SUPPLIED	8
ASSEMBLY	9
INSTALLING PTO DRIVESHAFT	12
DISCONNECTING PTO DRIVESHAFT	13
TRANSPORTATION	14
SPLITTER OPERATION	14
FREE A JAMMED LOG	18
REPLACING OIL	18
SHARPENING WEDGE	19
GEARBOX LUBRICATION	20
TROUBLESHOOTING	20
WIRING DIAGRAM PLUMBING DIAGRAM	21
PART LIST	22
DISPOSAL OF PACKAGING AND MACHINE AFTER THE END OF SERVICE LIFE	24
INSTRUCTIONS FOR ORDERING SPARE PARTS	24
ADDRESS OF THE MANUFACTURER	25
ADDRESS OF THE IMPORTER AND DISTRIBUTOR	25
LETTER OF GUARANTEE	27

Edition 2013. The manufacturer reserves the right to introduce technical modifications and innovations, which do not affect the function and safety of the machine. These modifications may not necessarily be specified in this user manual. Printing errors reserved.

INTRODUCTION

Your new log splitter will more than satisfy your expectations. It has been manufactured under stringent quality standards to meet superior performance criteria. You will find your new unit easy and safe to operate, and with proper care, it will give you many years of dependable service.



Carefully read through this entire operator's manual before using your new log splitter. Take special care to heed the cautions and warnings.

ENVIRONMENT



Recycle unwanted materials instead of disposing of them as waste. All tools, hoses and packaging should be resorted, taken to the local recycling centre and disposed of in an environmentally safe way.

SYMBOLS

The rating plate on your machine may show symbols. These represent important information about the product or instructions on its use.



Read these instructions in full before using the machine.



Keep your work space tidy!
Untidiness may result in accidents.



Do not remove or tamper with any protection or safety devices.



Wear safety footwear



Wear safety gloves



Wear eye protection.
Wear hearing protection.



Do not smoke or have open flames.



Keep bystanders away from the working area.

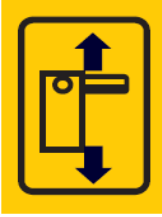

Avoid injury from the movement of the splitting blade.



Always keep hands out of the path of all moving parts.



Do not remove jammed logs with your hands.



Before starting any repairs, maintenance or cleaning, always disconnect the power.



Dispose of the used oil in an environment-friendly way.



Caution! Thrown objects.

SAFETY

SAFETY WARNINGS & INSTRUCTIONS

• UNDERSTAND YOUR LOG SPLITTER

Read and understand the owner's manual and labels affixed to the log splitter. Learn its application and limitations as well as the specific potential hazards peculiar to it. Be thoroughly familiar with the controls and their proper operation. Know how to stop the log splitter quickly by disengaging the PTO and shutting down the tractor.

• DRUGS, ALCOHOL AND MEDICATION

Do not operate the log splitter while under the influence of drugs, alcohol or any medication that could affect your ability to use it properly.

- **AVOID DANGEROUS CONDITIONS**

Always operate your log splitter on dry, solid, level ground. Never operate your log splitter on slippery, wet, muddy or icy surfaces. Never operate the machine while it is off the ground lifted by tractor 3-point draft arms. The location you choose should be free from any tall grass, brush or other interferences. There should be plenty of room for handling, and help the operator stay alert. Keep your work area clean and well lighted. Cluttered areas invite injuries. To avoid tripping, do not leave tools, logs or other components lying around the work area. Do not use the log splitter in wet or damp areas or expose it to rain. Do not use it in areas where fumes from paint, solvents or flammable liquids pose a potential hazard. Never start or run tractor inside a closed area. The exhaust fumes from tractor engines are dangerous, containing carbon monoxide, an odourless and deadly gas.

- **INSPECT YOUR LOG SPLITTER**

Check your log splitter before turning it on. Keep guards in place and in working order. Form a habit of checking to see that keys and adjusting wrenches are removed from tool area before turning it on. Replace damaged, missing or failed parts before using it. Make sure all nuts, bolts, screws, hydraulic fittings, hose clamps, etc. are securely tightened. Always check the oil level in the hydraulic oil tank. Never operate your log splitter when it is in need of repair or is in poor mechanical condition. Before starting work, test the stopping devices to keep them in safe working condition.

- **DRESS PROPERLY**

Do not wear loose clothing, gloves, neckties or jewellery (rings, wrist watches). They can be caught in moving parts. Protective, electrically non-conductive gloves, non-skid footwear and hearing protection are recommended when working. Wear protective hair covering to contain long hair, preventing it from get caught in machinery.

- **PROTECT YOUR EYES AND FACE**

Any log splitter may throw foreign objects into the eyes. This can cause permanent eye damage. Always wear safety goggles. Everyday eyeglasses have only impact resistant lenses. They are not safety glasses.

- **EXTENSION CORDS**

Improper use of extension cords may cause inefficient operation of the log splitter, which can result in overheating. Be sure the extension cord is not longer than 10 m and its section is not less than 2.5 mm² to allow sufficient current flow to the motor. Avoid use of free and inadequately insulated connections. Connections must be made with protected material suitable for outdoor use.

- **AVOID ELECTRICAL SHOCK**

Check that the electric circuit is adequately protected and that it corresponds with the power, voltage and frequency of the motor. Check that there is a ground connection. Ground the log splitter. Prevent body contact with grounded surfaces: pipes, radiators, ranges, and refrigerator enclosures. Never open the switch / plug box. Should this be necessary, contact a qualified electrician. Make sure your fingers do not touch the plug's metal prongs when plugging or unplugging the log splitter.

- **PREVENT FIRES**

Do not smoke or have open flames when operating or refilling the log splitter. Never operate the log splitter near a flame or candle. Oil is flammable and can explode.

- **KEEP BYSTANDERS AWAY**

Allow only one person to load and operate the log splitter. Always keep bystanders, including visitors, children and pets away from the work area, especially when the log splitter is under operation. Only the operator should stand near the machine and only within the safe operating area prescribed in this manual. Never use another people to help you with freeing jammed log. No one under the age of 16 should be allowed to operate the log splitter. Any individual under the age of 18 should have the necessary training, skills to perform the functions properly and safely and should always be under the supervision of adult.

- **INSPECT YOUR LOG**

Never attempt to split logs containing nails, wire or debris. Always make sure that both ends of the log you are splitting are cut as square as possible. This will prevent the log from sliding out of position while under pressure. Branches must be cut off the trunk.

- **DON'T OVERREACH**

Keep proper footing and balance at all times. Never stand on log splitter. Serious injury could occur if the tool is tipped or if the cutting tool is unintentionally contacted. Do not store anything above or near the log splitter where anyone might stand on the tool to reach it.

- **AVOID INJURY FROM UNEXPECTED ACCIDENT**

Do not straddle or reach across the splitting area when operating the log splitter. Never pile logs to be split in a manner that will cause you to reach across the log splitter. Only use your hands to operate the control levers. Never use your foot, knee, a rope or any other extension device. Never stand near the PTO driveshaft while it is in operation. Always pay full attention to the movement of the wedge ram. Never attempt to load your log splitter while the ram is in motion. Keep hands out of the way of all moving parts. Never try to split two logs on top of each other. One of them might fly up and hit you.

- **PROTECT YOUR HANDS**

Keep your hands away from splits and cracks which open in the log. They may close suddenly and crush or amputate your hands. Do not remove jammed logs with your hands.

- **DON'T FORCE TOOL**

It will do a better and safer job at its design rate. Don't use log splitter for a purpose for which it was not intended. Do not alter the equipment, or use the equipment in such a way as to circumvent its design capabilities and capacities. Never try to split logs larger than those indicated in the specifications table. Do not run the log splitter at a PTO shaft speed of more than 540 rpm maximum. Higher PTO shaft speed will damage the log splitter and may cause personal injury.

- **DISCONNECT POWER**

Whenever leave the operating position, always unplug and/or disengage PTO, shut down the tractor engine, remove the key, wait for all moving parts to come to a completely stop, disconnect the PTO driveshaft.

- **MAINTAIN YOUR LOG SPLITTER WITH CARE**

Before cleaning, repair, inspecting or adjusting, shut off the machine and make certain all moving parts have stopped. Always clean the unit after each use. Keep the log splitter clean for best and safest performance. Follow instructions for lubricating. Inspect all hydraulic seals, hoses and couplers for leaks prior to use. Control levers and power switch must be kept clean, dry and free from oil and grease at all times.

- **PROTECT THE ENVIRONMENT**

Take used oil to an authorized collection point or follow the stipulations in the country where the log splitter is used. Do not discharge into drains, soil or water.

- **MAKE THE WORKSHOP CHILDPROOF**

Lock the shop. Store the log splitter away from children and others not qualified to use it.

- **DEAL WITH ACCIDENT**

Always have a fire extinguisher and a first aid kit available for use should the need arise. In emergency always know the location of the nearest phone or keep a phone on the job site. Also know the phone numbers of the nearest ambulance, doctor and fire department. This information will be invaluable in the case of an emergency.

SPECIFICATIONS

Model		65687
Trade Name		VARI 20 TON SUPER FORCE DUO
Motor (400 V 3N~ 50 Hz)		S6 40 % IP54 5400 W
Log Size Capacity	Diameter	38 cm
	Length	110 cm
Maximum Force		20 t
Hydraulic Pressure		22,7 MPa
Hydraulic Oil Capacity		30 l
Ram Travel		94,5 cm
Speed	Forward	8,2 m/min
		3,0 m/min
	Retract	4,3 m/min
Noise Pressure Level (LpA)		≤ 75 dB (A)
Vibration		2,5 m/s ²
Overall Sizes	Length	154 cm
	Width	114 cm
	Height	252 cm
Weight		360,5 kg

APPLICATION CONDITIONS

This log splitter is designed for operating under ambient temperatures between +5°C and +40°C and for installation at altitudes not more than 1000 m above M.S.L. The surrounding humidity should be less than 50 % at 40°C. It can be stored or transported under ambient temperatures between -25°C and +55°C.

ELECTRICAL REQUIREMENTS

With 3 phase 400 Volt / 50Hz motor, the log splitter should be connected to standard 400V $\pm 10\%$ / 50Hz ± 1 Hz electrical supply which has protection devices of under-voltage, over-voltage, over-current as well as a residual current device (RCD) with maximum residual current rated at 0,03 A.

The mains connection and extension cable must have 5 wires = 3P + N + PE (3/N/PE). The mains connection must have maximum 8 A fuse. Electrical connection rubber cables must comply with IEC 60245, which is always marked with symbol H07RN-F. Cables should be identified, as it is a legal requirement. The cable is not supplied with the machine.

CONTENTS SUPPLIED

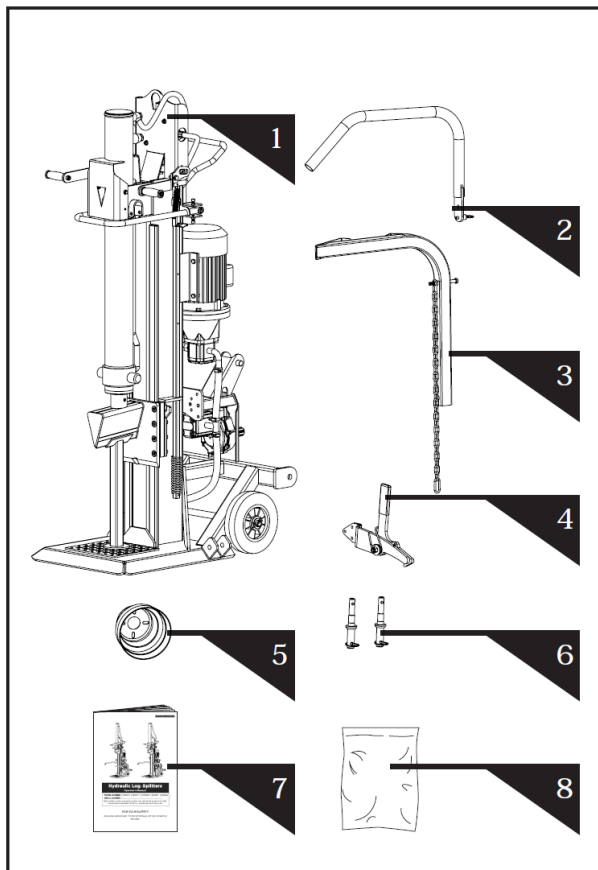

1. Log splitter frame & power station
2. Guard arm
3. Log lift
4. Retaining hook
5. PTO cover
6. Hookup pin
7. Operator's manual
8. Hardware bag, including

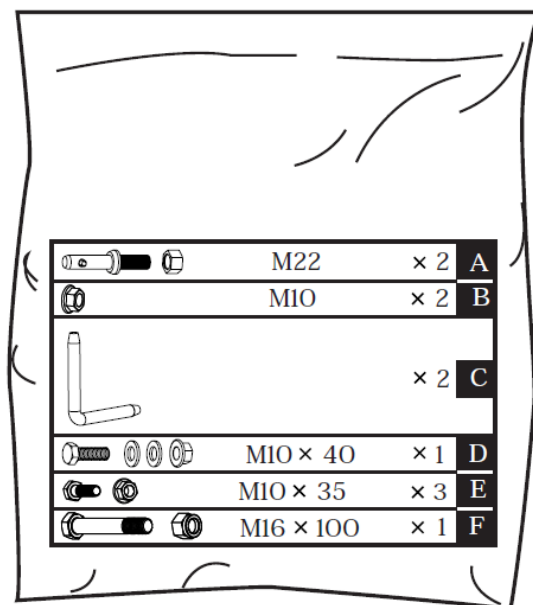

ASSEMBLY

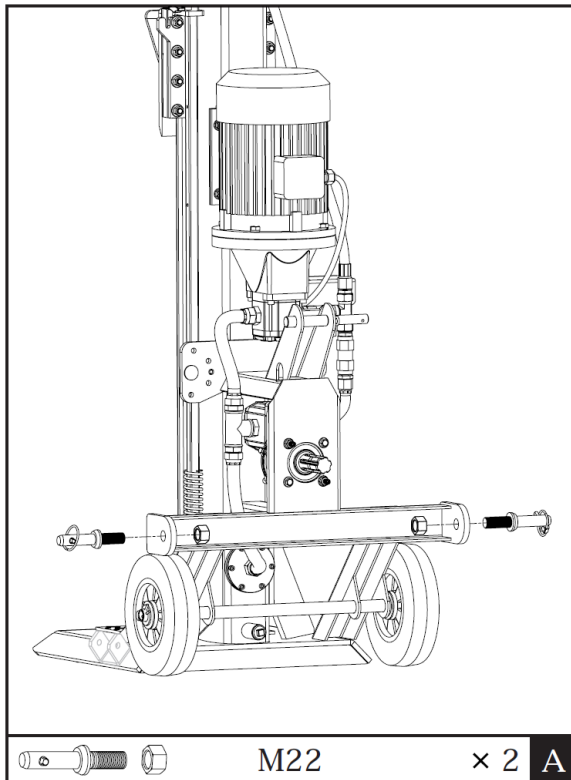

1. Secure the hookup pins to hitch bracket.

2. Attach the PTO cover to the splitter with two M10 nuts.

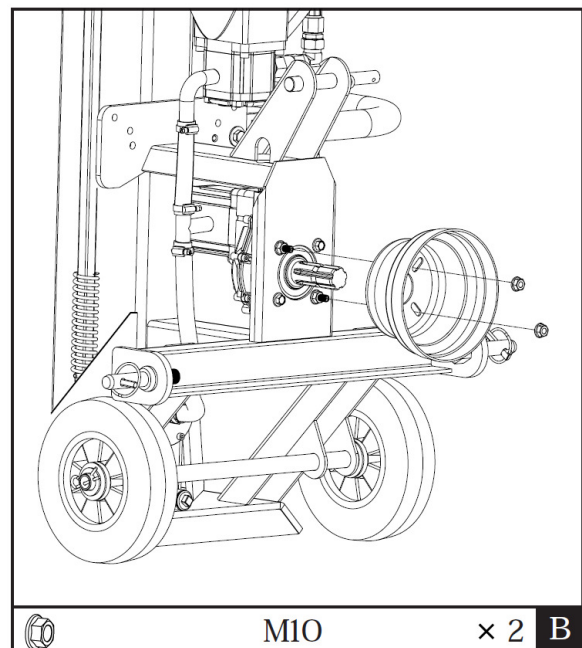

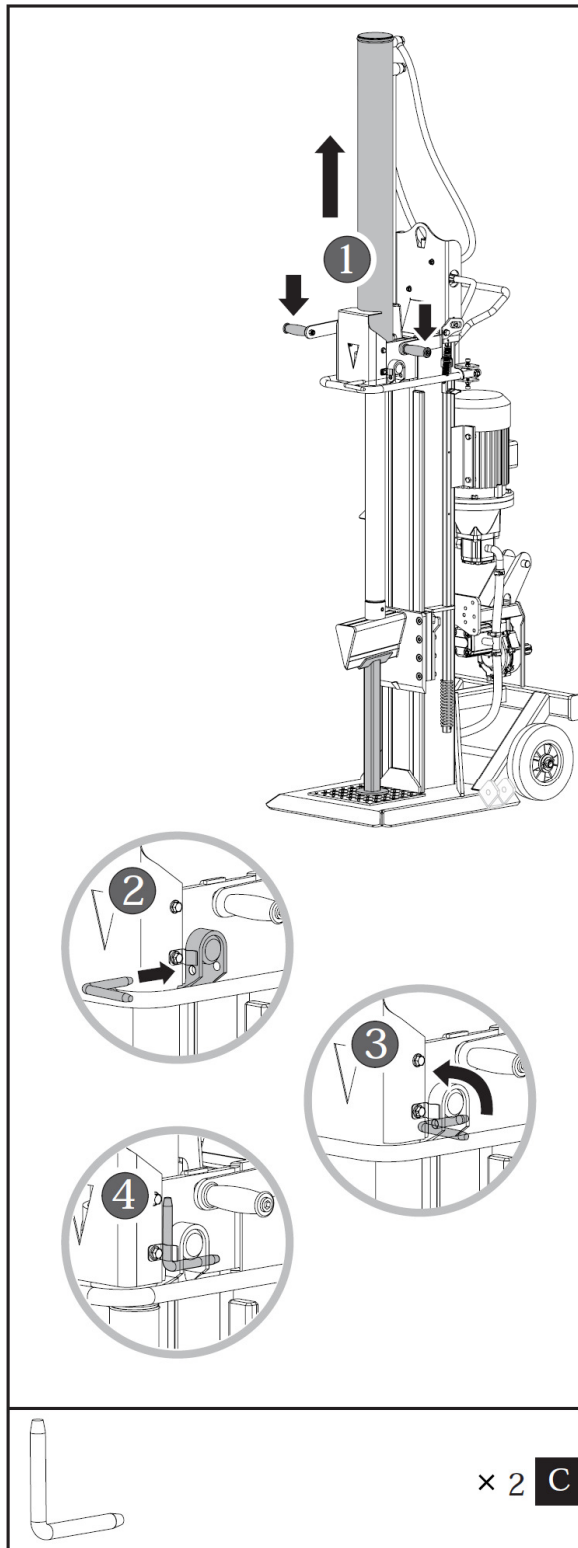

3. Keeping the support stand against the wedge, lower both control handles to expand wedge ram. Insert the L pins to secure the cylinder to the splitter. Lock the L pins into the spring tabs.

4. Release both control handles to retract the wedge ram. Remove the support stand.

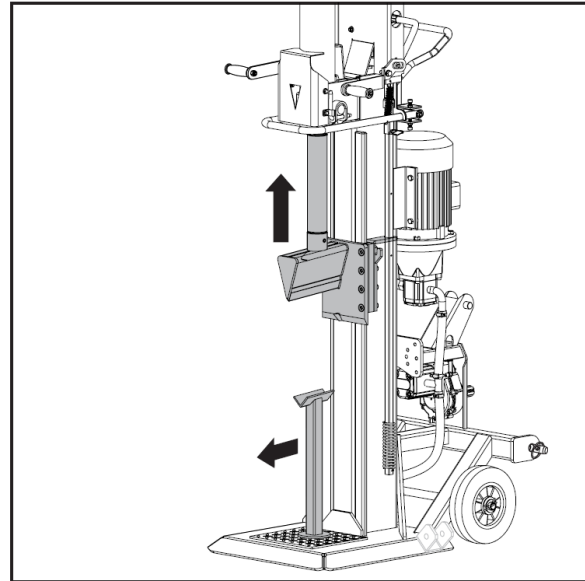
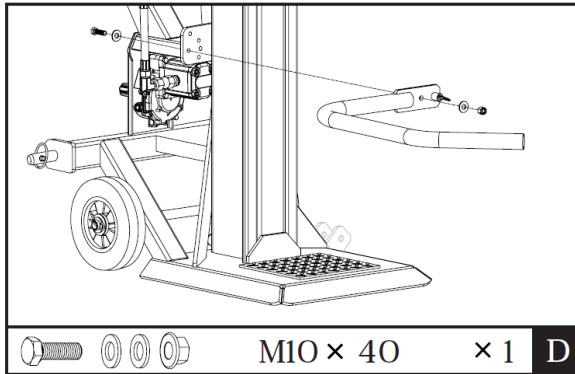

5. Align the hole and locking pin of the guard arm with the mount bracket. Secure the guard arm with a M10X40 hex bolts, two washers and a nut from the hardware bag.

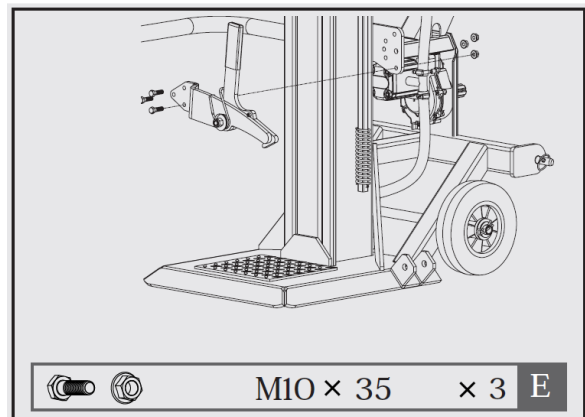

6. Position the retaining hook onto the frame and secure with three M10X35 hex bolts and nuts.

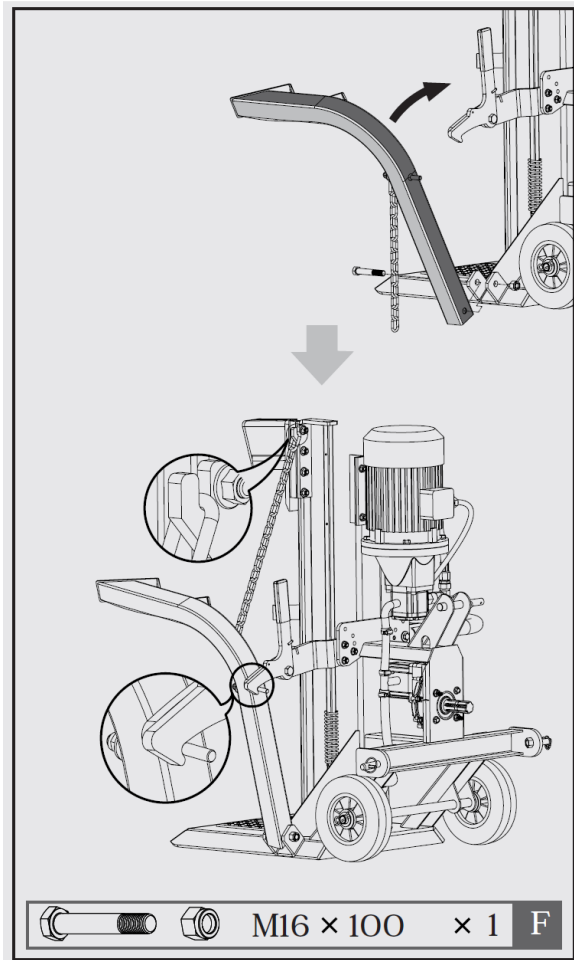

7. Position the log lift inside the mounting bracket and align with mounting bracket holes. Secure with a M16X100 hex bolt and nut. Hook the lift chain to wedge slide guide.

INSTALLING PTO DRIVESHAFT



The log splitter can be driven by a PTO driveshaft (not provided with the log splitter) that transmits torque from tractor during normal operation. The PTO driveshaft represents extreme danger. Read and understand all of the safety and operating instructions from the manual that came with the PTO driveshaft.

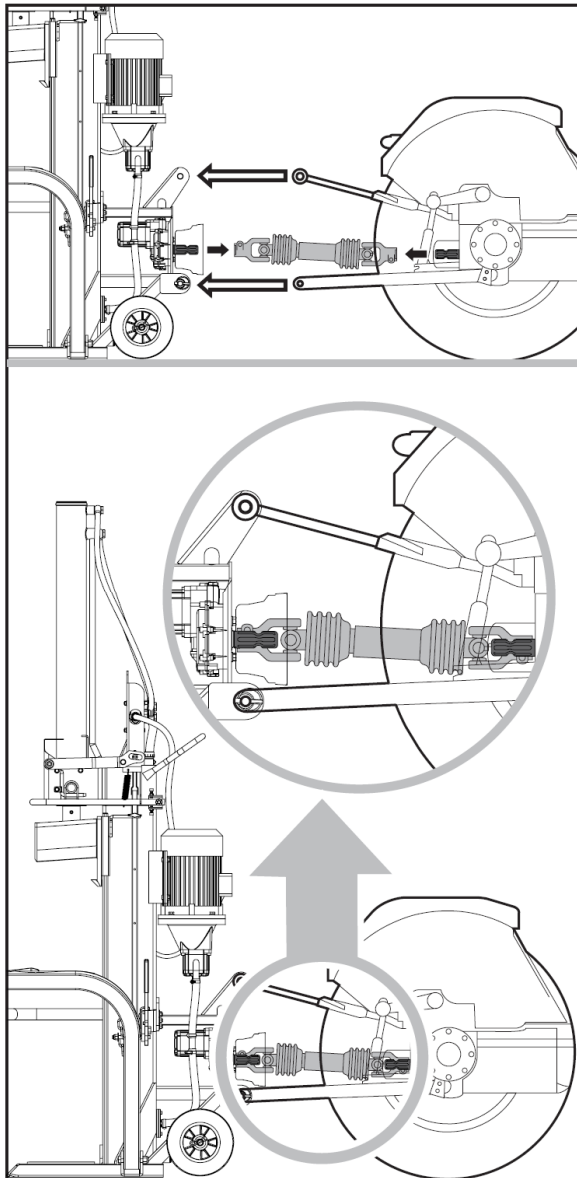



1. Back the rear of the tractor toward the log splitter. Position the lower draft arms close enough to the splitter's hookup pins. Apply the tractor parking brake and turn the engine off.

2. Block the rear wheels on both sides in front and back with wedges or other appropriate objects.
3. Slide the lower draft arms onto the splitter hookup pins and secure with locking pins.
4. Position the upper draft arm inside the mounting bracket and align with the mounting bracket holes. Insert the hitch pin to secure the upper draft arm in place.

 The PTO shaft end from the gearbox has a diameter of 1 3/8" (34,8 mm) and a 6-spine fitting (standard category 1 PTO).

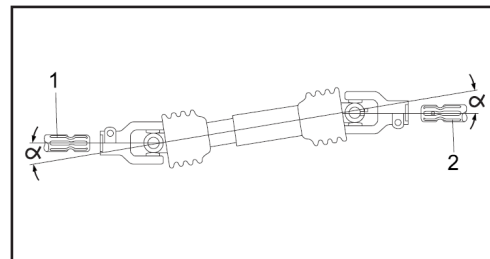
5. Slide the PTO driveshaft over the PTO shaft ends on the gearbox and tractor respectively. Press inward on the spring pins that are located on both ends of the PTO driveshaft. Continue sliding the driveshaft over the PTO shaft ends until the spring pins pop out and lock into the detents in the PTO shaft ends.



 Keep splitter PTO shaft end (1) and tractor PTO shaft end (2) parallel as viewed from above and from the sides of the shafts. Maintain PTO shaft joint angles (α) as small as possible.

6. Secure the PTO shaft safety chains to stationary parts of the log splitter and tractor to stop the guard from turning.

DISCONNECTING PTO DRIVESHAFT

1. Reduce tractor throttle to IDLE before disengaging PTO. Apply the parking brake and turn off the engine.

2. Pull up the locking pins and slide the lower draft arms of the tractor off from the splitter hookup pins.
3. Pull up the hitch pin and slide the upper draft arm off from the mounting bracket.
4. Release the spring pins located on both ends of the driveshaft. Slide the PTO driveshaft off from the PTO shaft ends on the gearbox and tractor respectively.

TRANSPORTATION

3-point attachment to tractor allows the log splitter to be moved easily.



Allow for added length in driving situations, e.g., when turning, parking, and crossing intersections.



Before transporting, be certain the log splitter is correctly and securely attached to the tractor and the safe chains of the PTO are in place.

Make sure the log splitter is raised high enough to clear all obstacles during transportation.

Never transport the log splitter with the PTO engaged.

SPLITTER OPERATION

Plan your work site. Work safely and save effort by planning your work beforehand. Have your logs positioned where they can be easily reached. Have a site located to stack the split wood or load it onto a nearby truck or another carrier. Position the log splitter on solid level ground.

Apply a thin coat of grease to the surfaces of the ram before operation will lengthen the durability of the ram.

Bleed the air out of the hydraulic system before starting the log splitter. The cover of the hydraulic oil tank should be loosened by some rotations until air can go in and out of the oil tank smoothly.

Air flow thru the oil tank filler should be detectable during the operations.

Before moving the log splitter, make sure the cover of the oil tank is tightened to avoid oil leaking from this point.

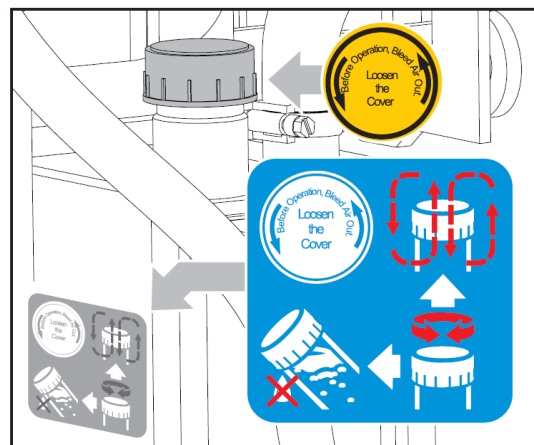

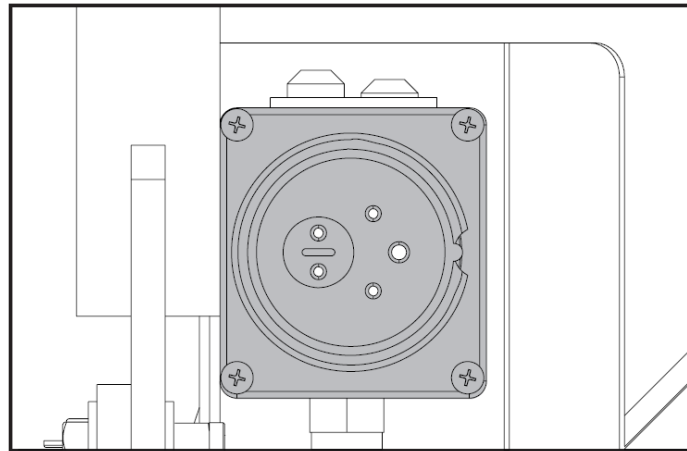

FAILED TO LOOSEN THE OIL TANK COVER WILL KEEP THE SEALED AIR IN HYDRAULIC SYSTEM BEING COMPRESSED AFTER BEING DECOMPRESSED. SUCH CONTINUOUS AIR COMPRESSION AND DECOMPRESSION WILL BLOW OUT THE SEALS OF THE HYDRAULIC SYSTEM AND CAUSE PERMANT DAMAGE TO THE LOG SPLITTER.

Turn the motor switch to the ON position to start the log splitter. To stop the machine, just turn the motor switch to the OFF position.



Make sure the direction of motor rotation is correct. Turn the motor on; the wedge ram should rise to the highest position automatically. If the wedge ram is already at the highest position when the motor starts, grip both control levers and lower them, the wedge ram should start to move downward.

If no ram motion is detected after the motor starts, power off the motor immediately to change motor polarity by turning the pole switching device inside the plug with a screwdriver.

			400 V 3N
Never allow motor running at counter direction. This will damage the pump and will void the warranty.			

Vývodová hřídel traktoru může pohánět samostatné hydraulické čerpadlo na štípači, které provádí funkci štípání polen. Před zapojením vývodu s připojeným štípačem nastavte otáčky traktoru na volnoběh. Před štípáním zvyšte otáčky traktoru na požadované provozní (540 ot/min). Před odpojením hřídele snižte otáčky traktoru na volnoběh.

	<p>Danger of log splitter tipping due to torque resulting during operating, causing serious injuries and damage. Log splitter must be secured by using 3-point attachment to tractor. Tractor hydraulics makes the log splitter secure against tipping over during operation, and yet allows it to be moved easily.</p> <p>Always ensure parking brake is engaged on tractor and the rear wheels are blocked with wheel chocks both sides in front and back.</p>
---	--

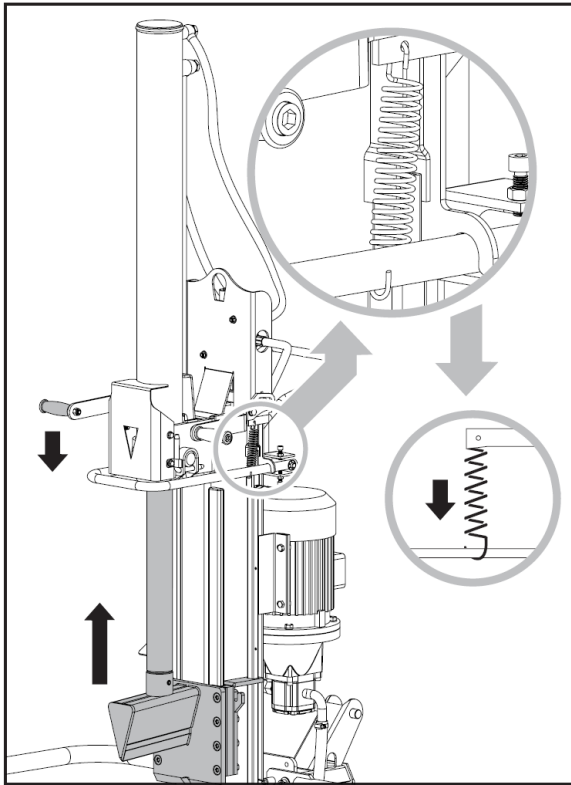

Operate the spring-loaded retract control lever to lift wedge above the height of log to be split.

To disengage the retract control lever by removing the loading spring will allow the wedge ram to retract automatically after both control handles are released.

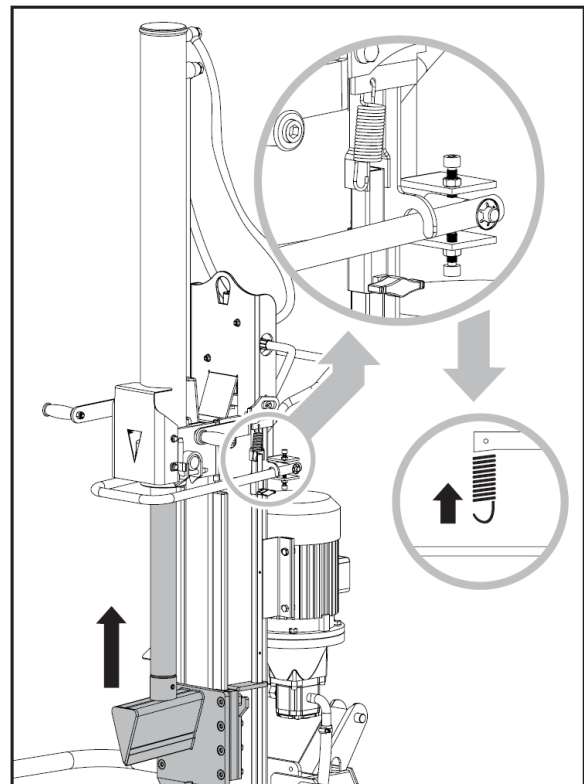

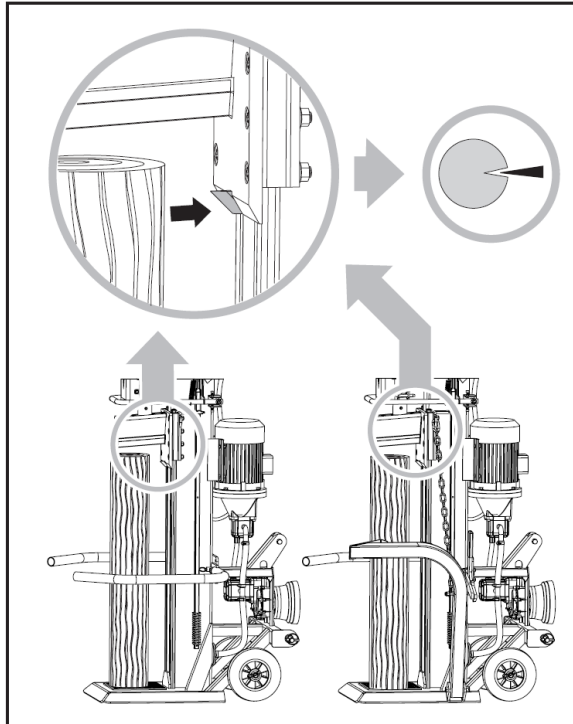

Place the log onto the support table vertically, sitting flat on the support table and push it against the hangnail to secure it. Be sure the wedge and support table will contact the log squarely on the ends. Never attempt to split a log at an angle. Lower the wedge until the log is split open.

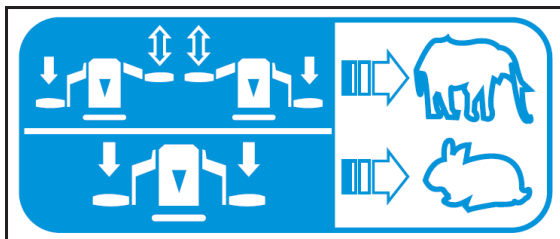

The splitting force and speed are governed by the 2-stage control handles. Lower both control handles completely for faster speed at less splitting force to split usual logs; Raise either control handle slightly for maximum splitting force at slower speed to split particularly hard and seasoned logs. These stages can be shifted by simply raising and lowering either control handle slightly.



Do not attempt to split green logs. Dry, seasoned logs split much more easily, and will not jam as frequently as green wood.



Break log in the direction of its growing grain. Do not place log across the log splitter for splitting. It may be dangerous and may seriously damage the machine.



Do not remove jammed logs with your hands. Never use another people to help you with freeing jammed log.

Stack as you work. This will provide a safer work area, by keeping it uncluttered, and avoid the danger of tripping, or damaging the power cord.



Accumulated split wood and wood chips can create a hazardous work environment. Never continue to work in a cluttered work area which may cause you to slip, trip or fall.

FREE A JAMMED LOG

Do not remove jammed logs with your hands. If jammed, stop the motor and loosen the log by a downward stroke on the log with a hammer.

REPLACING OIL

The hydraulic system is a closed system with oil tank, oil pump and control valve. Low oil levels can damage the oil pump.

Check oil level regularly with dipstick. The oil should be completely changed once a year.

Following hydraulic oils or equivalent are recommend for the log splitter's hydraulic transmission system:

SHELL Tellus 22

MOBIL DTE 11

ARAL Vitam GF 22

BP Energol HLP-HM 22

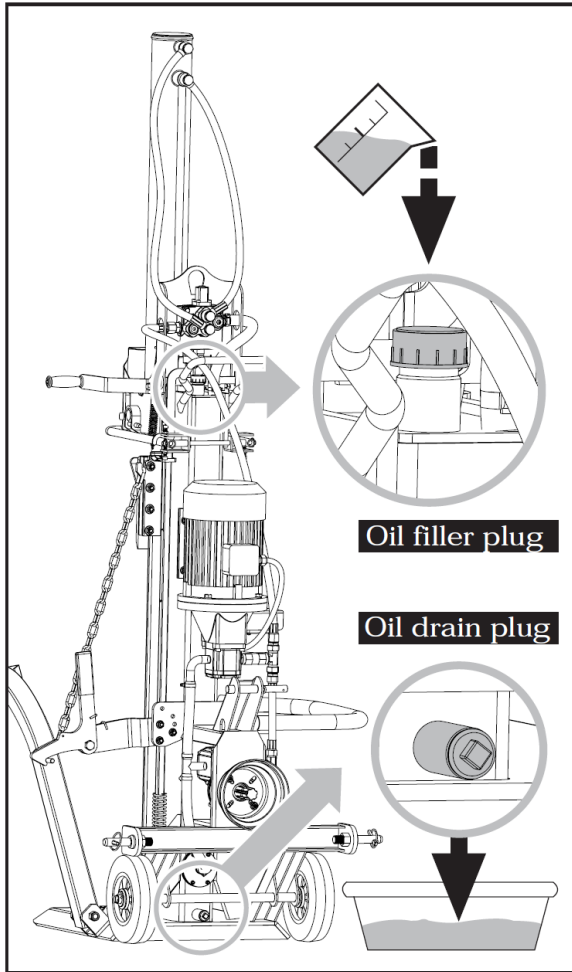

Make sure moving parts stop and the log splitter is unplugged and PTO driveshaft is disconnected.

Use a drain pan to aid in the removal of all used oil and particles.

Remove oil drain plug to drain oil from the hydraulic transmission system. Examine oil for metal chips as a precaution to future problems.

After oil has been completely drained from the machine, reinstall drain plug.

Add the hydraulic transmission system with recommended oil through filler plug opening.

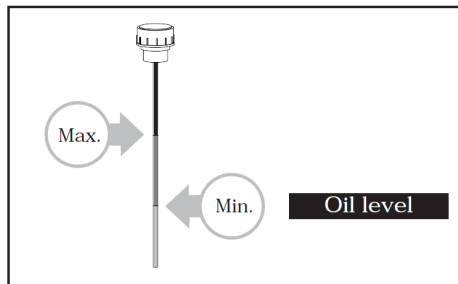

Read dipstick to determine the maximum and minimum of the oil level. Low oil can damage the oil pump. Overfilling can result in excessive temperature in the hydraulic transmission system.

Apply sealant to filler plug and reinstall it.

Following an oil change, activate the log splitter a few times without actually splitting.

SHARPENING WEDGE

This log splitter is equipped with reinforced splitting wedge which blade is specially treated. After long periods of operation, and when required, sharpen the wedge using a fine-toothed file removing any burrs or flat spots on the edge.

GEARBOX LUBRICATION

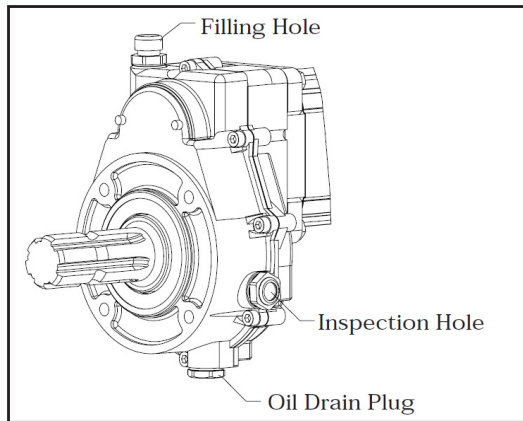

The gearbox is pre-serviced using SAE 90 gear oil. Drain the gear oil after first 25 hours of use and refill with fresh oil as specified. Then change after every 250 hours of use or every six months, whichever is earlier.

After each oil change check that the correct amount of oil has been poured into the gearbox.

Check oil every 8 hours: Oil level is correct if the lower edge of the inspection hole is nearly covered with oil.

TROUBLESHOOTING

PROBLEM	PROBABLE CAUSE	REMEDY SUGGESTED
Motor does not start	Switch is OFF	ON the switch
Incorrect motor rotation direction	Incorrect connection	Change pole switching device in the plug with a screwdriver
		Reverse polarity by electrician
Log Splitter does not work while motor running	Valve is not opened owing to the connection parts loosening	Check and tighten the parts
	Control Levers or connection parts bent	Repair the bent parts
	Lower hydraulic oil level	Check and refill hydraulic oil
Log Splitter works with abnormal vibration and noise	Lower hydraulic oil level	Check and refill hydraulic oil



ATTENTION: ALL REPAIR WORK MUST BE DONE BY A SPECIALIST FOR THIS PRODUCT.

WIRING DIAGRAM

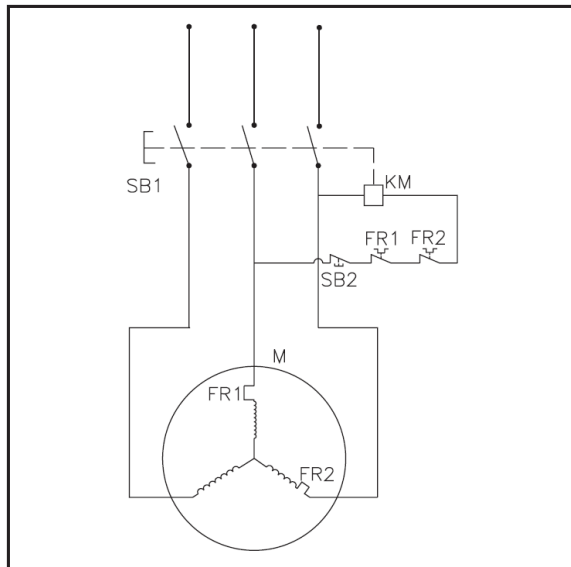

PLUMBING DIAGRAM

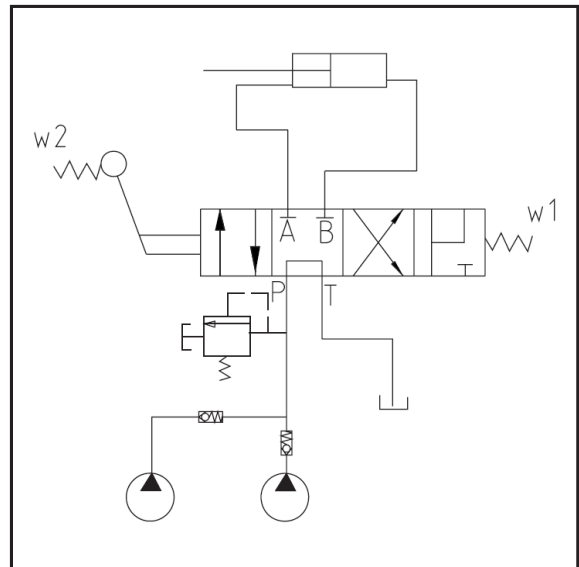

PART LIST

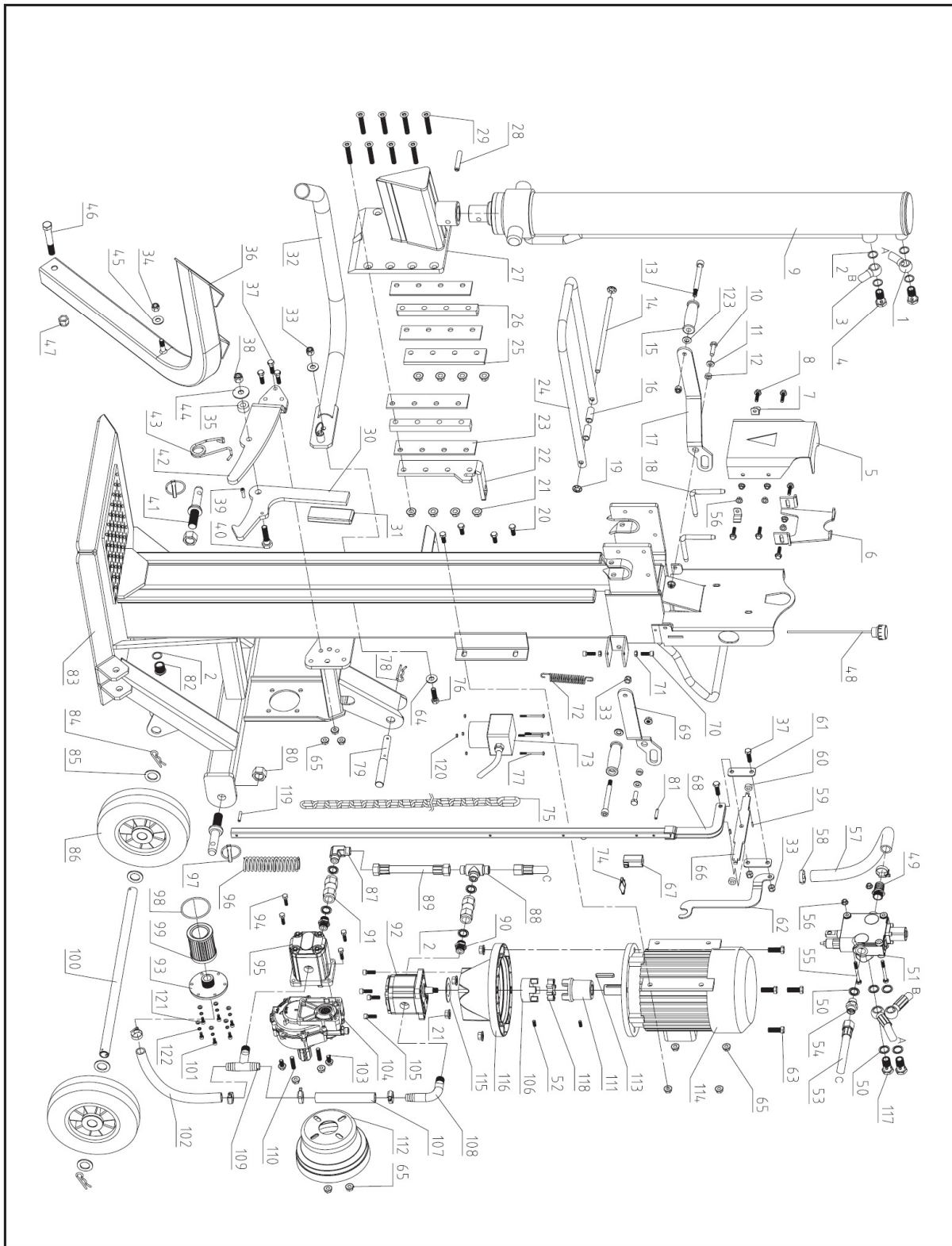

Pos.	Part No.	Name	Pcs	Pos.	Part No.	Name	Pcs
1	220001	Upper high pressure hose	1	63	220063	Bolt M12x45	4
2	220002	Seal kit 22	9	64	220064	Spring gasket 10	2
3	220003	Lower high pressure hose	1	65	220065	Flange nut M10	13
4	220004	Hose link	2	66	220066	Binder plate	1
5	220005	Upper guard	1	67	220067	Regulating sleeve	1
6	220006	Lock plate	1	68	220068	Draw bar	1
7	220007	Pin	2	69	220069	Arm right	1
8	220008	Bolt M8x35	6	70	220070	Screw M8x25	4
9	220009	Cylinder	1	71	220071	Nut M8	4
10	220010	Bolt M10x25	2	72	220072	Spring	1
11	220011	Washer 10	2	73	220073	Switch	1
12	220012	Sleeve 2	2	74	220074	Knob	1
13	220013	Screw	2	75	220075	Chain	1
14	220014	Lock shaft	1	76	220076	Bolt M10x40	1
15	220015	Grip	2	77	220077	Screw M4x60	4
16	220016	Sleeve	2	78	220078	Spring pin	1
17	220017	Arm left	1	79	220079	Pin	1
18	220018	Cylinder pin	2	80	220080	Nut M22x1,5	2
19	220019	Spring gasket 12	2	81	220081	Pin 6x35	1
20	220020	Bolt M10x25	4	82	220082	Plug M22x1,5	1
21	220021	Flange nut M12	12	83	220083	Splitting frame weldment	1
22	220022	Plate right	1	84	220084	Wire clip	6
23	220023	Plate middle	4	85	220085	Washer 24	4
24	220024	Lock stop	1	86	220086	Wheel	2
25	220025	Plate left	1	87	220087	Angle fitting 2 – M22x1,5	1
26	220026	Clamp plate	2	88	220088	High pressure T-cock	1
27	220027	Wedge weldment	1	89	220089	High pressure hose 1	1
28	220028	Pin 12x70	1	90	220090	Hose fitting	2
29	220029	Screw M12x70	8	91	220091	Valve	2
30	220030	Latch	1	92	220092	Pump 1	1
31	220031	Grip	1	93	220093	Flange	1
32	220032	Guard bracket left	1	94	220094	Screw M8x30	4
33	220033	Locknut M10	5	95	220095	Pump 2	1
34	220034	Locknut M12	1	96	220096	Buffer spring	1
35	220035	Lock spring	1	97	220097	Spring pin	2
36	220036	Hoist guard	1	98	220098	O-ring 75x2,65	1
37	220037	Bolt M10x35	5	99	220099	Oil filter	1
38	220038	Nut M14	1	100	220100	Wheel axle	1
39	220039	Screw M6x10	1	101	220101	Screw M6x14	6
40	220040	Screw	1	102	220102	Inlet hose 1	1
41	220041	Pin	2	103	220103	Hex bolt M10x20	2
42	220042	Lock plate	1	104	220104	Speed increaser	1
43	220043	Reset spring	1	105	220105	Screw M8x30	4
44	220044	Washer 14	1	106	220106	Coupler 1	1
45	220045	Big washer 12	1	107	220107	Inlet hose 2	1
46	220046	Bolt M16x100	1	108	220108	Angle fitting	1
47	220047	Nut M16	1	109	220109	T-cock	1
48	220048	Cap	1	110	220110	Screw M10x40	2
49	220049	Hose fitting	1	111	220111	Coupler 2	1
50	220050	Washer 20	5	112	220112	Spline shaft guard	1
51	220051	Control valve	1	113	220113	Spline	1
52	220052	Screw M8x15	2	114	220114	Motor	1
53	220053	Clamp hose 2 D12	1	115	220115	Ring	1
54	220054	Half union	1	116	220116	Cone frame	1
55	220055	Bolt M8x65	2	117	220117	Valve fitting	1
56	220056	Flange nut M8	8	118	220118	Coupler ring	1

57	220057	Oil return hose	1	119	220119	Pin 6x45	1
58	220058	Hose clamp	6	120	220120	Nut M4	4
59	220059	Spring pin 3x16	2	121	220121	Washer 6	6
60	220060	Lock plate	2	122	220122	Spring gasket 6	6
61	220061	Fitting plate	2	123	220123	Washer 12	2
62	220062	Adjustable plate	1				

DISPOSAL OF PACKAGING AND MACHINE AFTER THE END OF SERVICE LIFE

After unpacking the machine, you are obliged to provide for the disposal of packaging material with taking into account the use of secondary raw materials according to the legislation valid in your country and with respect to the decrees of local town or municipal authorities.

The following procedure is recommended for machine disposal after the end of its service life:

1. Dismount all parts from the machine that can still be used.
2. Dismount plastic machine parts and parts made of non-ferrous metals. The dismantled machine remainder and the dismantled parts are to be disposed according to the legislation valid in your country and with respect to the decrees of local town or municipal authorities.
3. Regarding waste from the electrical device, use the opportunity of **return buy-out** in the shop, where you purchased the device (**points 1 and 2 are not valid in this case**).
4. The machine is in accordance with the RoHS Directive (2002/95/EC, 2002/96/EC, 2003/108/EC).
5. The product is in accordance with the requirements of the above-mentioned EC Directive regarding the quantities of forbidden dangerous substances.



This pictograph means that the product was introduced on the market after 13th September 2005 and shall not be disposed to a waste container or a dustbin.

INSTRUCTIONS FOR ORDERING SPARE PARTS

The following data are to be used for an easier identification when ordering the spare parts:

1. Machine type, engine type, machine serial number and year of manufacture;
2. Ordering number given by manufacturer and its name in the part list;
3. Number of ordered pieces separately for each item;
4. Precise address, telephone number, fax number or e-mail address;
5. Should you be uncertain about the correct identification of the component, send the damaged component either to the nearest service shop or directly to the manufacturer;
6. All components should be ordered in the nearest service shop or at your dealer's.

In the case of any confusions concerning the spare parts or technical issues, the VARI a.s. commercial, customer-service or technical departments are prepared to answer all your inquiries.

ADDRESS OF THE MANUFACTURER

TIYA International Co., Ltd., B12B, Shenyue Centre, 9 Shandong Road, Qingdao, P.R.China

ADDRESS OF THE IMPORTER AND DISTRIBUTOR

VARI, a.s.	phone:	(+420) 325 607 111
Opolanska 350	fax:	(+420) 325 607 264
Libice nad Cidlinou	e-mail:	vari@vari.cz
CZECH REPUBLIC	internet:	http://www.vari.cz/
289 07		

EC DECLARATION OF CONFORMITY

according to Act No. 22/1997 Gaz.
(as amended)

Importer:

VARI,a.s. , Opolanská 350, 289 07 Libice nad Cidlinou, Czech Republic

Registration No.: 00660574 , VAT No.: CZ00660574 . Registered in the Company Register at Municipal Court of Prague on 29 January 1991 Section B, Insert 499.

issue the following statement at their own responsibility:

Description of the electrical device:

Trade mark	Name	Type	Serial nos.
VARI	Log splitter	VARI 20 TON SUPER FORCE DUO	000001-999999
Input	5400W/400V	Weight	360,5 kg
Pressure force	20 tons	Log length	up to 1100 mm

The **VARI 20 TON SUPER FORCE** (model 65687) log splitter is intended for simple splitting of wood logs. A ram pushes the log on a sharp wedge which breaks the wood log. This log splitter is intended for logs with a diameter of up to 380 mm. The machine drive is electro hydraulic. This model can also be driven by the tractor PTO.

Regulations according to which the conformity was assessed:

NV No. 17/2003 Gaz. (2006/95/EC), NV No. 616/2006 Gaz. (2004/108/EC), NV No. 176/2008 Gaz. (2006/42/EC)
(all Decrees of the Government /NV/ and directives as amended)

Authorized person which made the measurements:

Jiangsu TÜV SÜD Product Service Ltd. (Shanghai branch), No. 10 Heng Tong Road, Shanghai, 200070, P. R. China

Test report: 70520113630200

Jiangsu TÜV SÜD Product Service Ltd. Beijing branch, Unit 918, Landmark Tower 2, 8 North Dongsanhuan Road, Beijing, 100004, P.R. China

Test report: 888001101001

Authorized person which issued the certificates:

TÜV SÜD Product Service GmbH, Ridlerstrasse 65, 80339 München, Germany

Certificates: N8M111166014012, M8A111166014013, E8N120366014018

Harmonised technical standards and technical specifications used:

EN609-1/A2:2009, EN60204-1:2006+A1:2009, EN60034-1/A11:2002,
EN55014-1/A1:2009, EN55014-2/A2:2008, EN61000-3-2/A2:2009, EN61000-3-11:2000

Last two digits of the year when the product was marked with CE: 11

Technical documentation file No. in which the product's compliance with the regulations is assessed: STD/012/2013

We declare that: This machine, as defined with the above-mentioned data, complies with the basic requirements of the Government Decree (NV) and technical regulations and is safe under conditions of usual or by the manufacturer specified use. Furthermore precautions have been made to guarantee conformity of all products introduced on the market with the technical documentation and requirements of the technical regulations. The machine is safe under conditions of usual or specified use.

Place of issue of the declaration of conformity: Libice nad Cidlinou **Date: 16.7.2013**

Name, surname and function of the person authorized to sign this EC Declaration of Conformity:

Jiří BELINGER, Director General (CEO) and Chairman of the Board of Directors VARI,a.s.

Signature:



Stamp:

VARI® - Konstrukce
Opolanská 350
289 07 Libice nad Cidlinou
DIČ: CZ00660574

LETTER OF GUARANTEE

To be completed by importer

Name of product **Log splitter**
 Model **VARI 20 TON SUPER FORCE DUO**
 Serial number
 Engine serial number
 Warranty (months) **24**
 Output control

The above product was passed over to the purchaser without any defects including the appropriate commercial and technical documentation and accessories. The purchaser was duly informed about the principles of sound operation and technical maintenance of the product.

To be completed by seller

Name of purchaser
 Address of purchaser
 Purchaser's signature
 Place of sale
 Date of sale

Seller's stamp and signature

GUARANTEE CONDITIONS

Subject of warranty:

Warranty relates to the basic product including accessories supplied by VARI a.s.

Warranty period:

Warranty period for the product and accessories supplied with the product is 24 months from the date of sale to the purchaser. Time from the enforcement of liability for defects to the date when the user was obliged to take over the thing after the end of repair is not included in the warranty period.

The seller is obliged to give the purchaser a receipt confirming the date of the right exercise and repair and the time of its duration. If the product is exchanged, the warranty period starts running again from the date on which the purchaser took over the new product. If it is a whole assembly to be replaced, the warranty period starts running for the given assembly again from the date of product take-over.

Scope of manufacturer's liability:

Importer bears responsibility for the product having properties usual for the kind of the product in question and specified parameters for the whole period of warranty. The importer does not answer for defects of the product resulting from current wear or from the product's use for purposes other than specified.

Warranty extinction:

Claim of warranty extincts if:

- the product was not used and maintained as specified in the Operating manual, or it was damaged by any unauthorized operation by the user;
- the product was used in conditions or for purposes other than specified;
- the letter of guarantee for the product cannot be presented;
- data filled in the original product's documentation by the manufacturer, seller or service organization were intentionally falsified;
- a part of the product was replaced with a non-original component;
- the product was damaged or excessively worn due to improper maintenance;
- the product suffered an accident or was damaged by an Act of God;
- a modification was made to the product without manufacturer's consent;
- defects result from improper storage of the product;
- defects result from natural and common operating wear of the product;
- the product was connected to or operated with the equipment not approved by the manufacturer.

Complaints:

Complaints are applicable by purchasers at the seller's. When applying a complaint, the purchaser is obliged to submit a duly filled in letter of guarantee. Warranty repairs are carried out by sellers or by special service shops appointed by them.

Legislation:

Other purchaser/seller relations follow appropriate provisions of the legal regulations according to national legislation in the country of sale.

Warranty inspection 1 Date: Person in charge: Service shop stamp and signature	Warranty inspection 1 Machine model..... Serial No.:
Warranty inspection 2 Date: Person in charge: Service shop stamp and signature	Warranty inspection 2 Machine model..... Serial No.:
1st Warranty service Date of complaint delivery: Date of repair: Brief description of the defect: Replaced parts (new warranty of ... months): Parts: Repair made by: Service shop stamp and signature	1st Warranty service Machine model..... Serial No.: Date: Repair made by: Stamp and signature:
2nd Warranty service Date of complaint delivery: Date of repair: Brief description of the defect: Replaced parts (new warranty of ... months): Parts: Repair made by: Service shop stamp and signature	2nd Warranty service Machine model..... Serial No.: Date: Repair made by: Stamp and signature:
3rd Warranty service Date of complaint delivery: Date of repair: Brief description of the defect: Replaced parts (new warranty of ... months): Parts: Repair made by: Service shop stamp and signature	3rd Warranty service Machine model..... Serial No.: Date: Repair made by: Stamp and signature:
4th Warranty service Date of complaint delivery: Date of repair: Brief description of the defect: Replaced parts (new warranty of ... months): Parts: Repair made by: Service shop stamp and signature	4th Warranty service Machine model..... Serial No.: Date: Repair made by: Stamp and signature: