

## **NM 1-001 Carrier of potato hillers**

### I. USE

The potato hiller carrier is designed to carry two potato hillers (type AHR-355, AHR-360, SV-1) during potatoes clamping and closing.

### II. TECHNICAL DESCRIPTION

Two adjustable holders are attached to the carrier for gripping the potato hillers (AHR-355, AHR-360, SV-1). Further a foot is welded on the carrier, with a hole for mounting a marker. The carrier is attached to the BZN-002 hitch. There are two screws in the carrier hitch which serve to define the clearance for attachment to the gearbox. The carrier contains a marker which is designed to maintain the required spacing of the drills.

### III. TECHNICAL DATA

Length	520 mm
Width	700 mm
Weight	ca 20.5 kg (incl. the potato hillers)
Max. working width	625 mm

### IV. SERVICE MANUAL

**Notice:** Before clamping, the soil must be prepared thoroughly using rotary tiller in sufficient depth.

The potato hillers are slipped into the shank holders and secured in required position with a cotter. The holders shall be adjusted to required spacing of the drill(s) and secured by tightening the M12 nuts. Marker shall be mounted in the hole of the foot which is welded in the centre of the frame, and secured with the cotter. Chain with an eye shall be adjusted in required spacing from the potato hiller axis (same with the span of the hiller) and secured in the position with M6 bolt. 5 kg weight will then be put on the weight carrier. The hitch of the carrier is attached to the hitch on the gearbox and secured with a pin. Clamping

itself shall be done at 1st speed gear with the BZN-002 hitch turned by 180° so that the clamping device was before the travelling part and the already loosened soil was not driven over. Once the first two drills are created, we approach the next one so that the chain of the marker copied the bottom of the already created drill and we proceed further in the same way.

When closing the already planted potatoes we drive with the potato hillers to the centres of the drills thus closing the potatoes.

We do not use the marker any more for closing.

### V: CATALOGUE OF SPARE PARTS

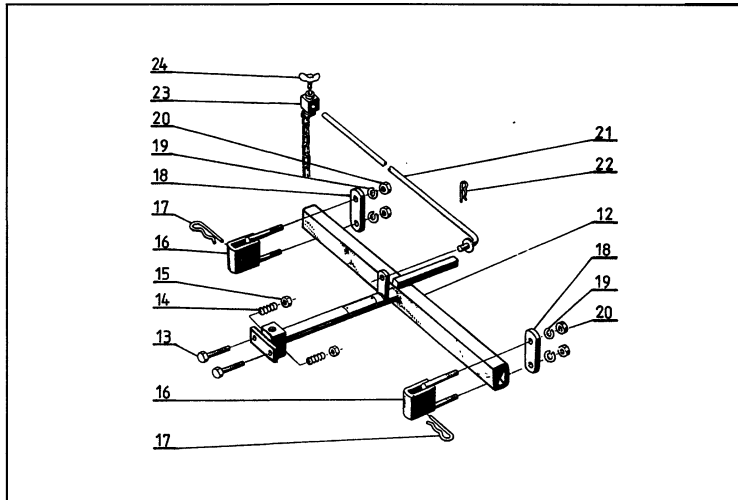

Č. poz. Item No. Pos. Nr. Кодирис	Název dílu	Part Name	Teil - Benennung	Название части	Číslo výkresu Drawing No. Zeichnung - Nr. № чертежа	Objednávací číslo Ordering Number Bestell - Nr. Заказной номер	Počet kusů Quantity pieces Stückzahl No. штук
12	Rám svařený	Welded Frame	Rahmen, geschweißt	Рама сварная	532-9-1238-004	115500	1
13	Šroub M10x50 ČSN 021103.25	Bolt	Schraube	Болт		115506	2
14	Pružina 1.6x141x34x8.5 ČSN 02 6020.0	Spring	Feder	Пружина		124500	2
15	Matice M10 ČSN 02 1401.24	Nut	Mutter	Гайка		106529	2
16	Držák slupice	Trash-Rack Holder	Halter des Scharstiels	Держатель пилки	532-9-1436-003	115501	2
17	Závlačka	Cotter Pin	Splint	Шплинт	532-0-9645-002	121523	2
18	Příložka	Strip Plate	Beilageplatte	Подкладка	532-0-1947-002	115502	2
19	Podložka 12 ČSN 02 1740.05	Washer	Unterlegscheibe	Шайба		106532	4
20	Matice M12 ČSN 02 1401.05	Nut	Mutter	Гайка		106531	4
21	Rameno svařené	Welded Arm	Arm, geschweißt	Плечо сварное	532-9-1364-006	115503	1
22	Závlačka	Cotter Pin	Splint	Шплинт	532-0-9645-001	106524	1
23	Řetěz s okem	Chain with Eye	Kette mit dem Augen	Цепь с глазком	532-9-1958-006	115504	1
24	Šroub M6x10 ČSN 02 1365	Screw	Schraube	Винт		115505	1

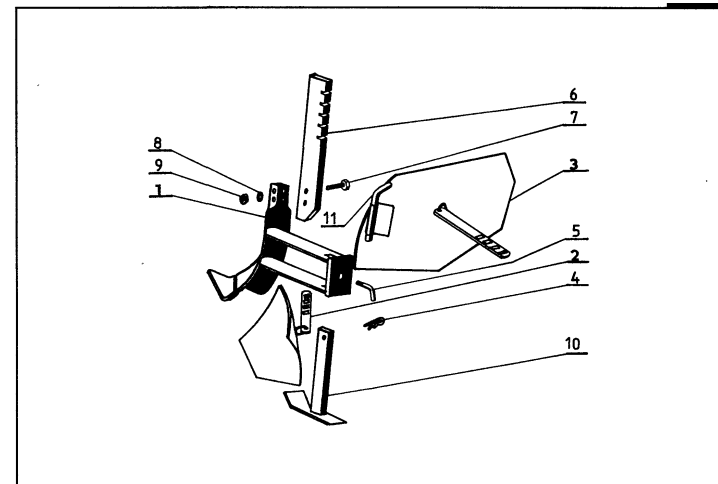

Č. poz. Item No. Pos. Nr. Кодирис	Název dílu	Part Name	Teil - Benennung	Название части	Číslo výkresu Drawing No. Zeichnung - Nr. № чертежа	Objednávací číslo Ordering Number Bestell - Nr. Заказной номер	Počet kusů Quantity pieces Stückzahl No. штук
1	Těleso radlice	Share Body	Scharkörper	Тело лемеха	532-9-4247-002	116503	1
2	Úprná odhmovací deska levá	Left Share Plate Assembly	Streichbrett, komplett, links	Плита отвала левая комплектная	532-9-4272-007	116500	1
3	Úprná odhmovací deska pravá	Right Share Plate Assembly	Streichbrett, komplett, rechts	Плита отвала правая комплектная	532-9-4272-006	116504	1
4	Závlačka	Cotter Pin	Splint	Шплинт	532-0-9645-001	106524	1
5	Šroub	Screw	Schraube	Винт	532-0-1940-015	116505	1
6	Držák slupice	Trash-Rack Holder	Halter des Scharstiels	Держатель гриделя	532-9-4230-002	116502	1
7	Šroub M8x20 ČSN 02 1101.25	Bolt	Schraube	Болт		101-2422	2
8	Podložka 6 ČSN 02 1740.05	Washer	Unterlegscheibe	Шайба		104574	2
9	Matice M8 ČSN 02 1401.25	Nut	Mutter	Гайка		180-0185	2
10	Úprný plaz	Slider Assembly	Plugschle, komplett	Плитка плуца комплектная	532-9-4246-007	116501	1
11	Kolík	Pin	Stift	Штифт	532-0-4940-004	116506	2