

# VARI®

## Electric chain saw VARI 2300 W

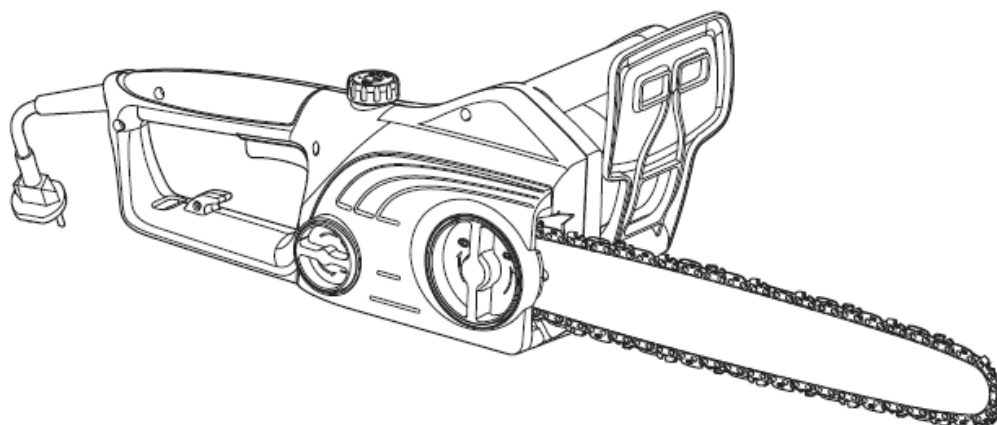

*Instructions for use  
(Original instructions for use)  
2010*

## Contents

Description of symbols.....	2
General safety instructions .....	3
Special safety instructions.....	5
Description of machine parts .....	6
Bar and chain assembly (Fig. 1-4) .....	6
Safety chain brake.....	7
Switching On/Off .....	7
Electric motor safety system .....	7
Maintenance.....	8
Chain sharpening .....	8
General suggestions for cutting.....	9
Specifications.....	12
Declared noise and vibrations values .....	12
Disposal of packaging and machine after the end of service life .....	12
Instructions for ordering spare parts .....	13
Address of the seller .....	13
Spare part list.....	14
Declaration of conformity .....	16
Letter of guarantee .....	18

**Caution: Before using the product, please read this manual carefully to understand the proper use of your unit. Keep this manual handy.**

## Description of symbols

Symbols are used in this manual to attract your attention to possible risks. The safety symbols and the explications which accompany them must be perfectly understood. The warning themselves do not prevent the risks and cannot be a substitute for proper methods of avoiding accidents.



Before any use, refer to the corresponding paragraph in the present manual.



This symbol, before a safety comment, indicates a precaution, a warning or a danger. Ignoring this warning can lead to an accident for yourself or for others. To limit the risk of injury, fire, or electrocution always apply the recommendations indicated.



These symbols indicate the requirement of wearing ear protection, eye protection and gloves when using the product.



Do not expose and operate the tool in rain.



Remove the plug from the mains immediately if cable is damaged or cut.

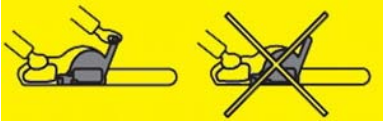

Hold the chain saw with both hands.

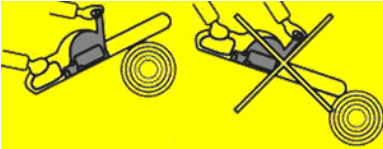

Right way of operation.

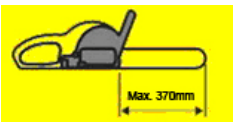

Bar length 400 mm, maximum cutting length 370 mm.

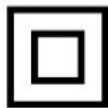

Double insulation.



Recycle unwanted materials instead of disposing of them as waste. All tools, hoses and packaging should be sorted, taken to the local recycling centre and disposed of in an environmentally safe way.

## General safety instructions



### WARNING!

**Read all safety warnings and all instructions.** Failure to follow the warnings and instructions may result in electric shock, fire and/or serious injury.

**Save all warnings and instructions for future reference.**

The term "power tool" in the warnings refers to your mains-operated (corded) power tool.

## Work area safety

- 1) Keep work area clean and well lit. Cluttered or dark areas invite accidents.
- 2) Do not operate power tools in explosive atmospheres, such as in the presence of flammable liquids, gases or dust. Power tools create sparks which may ignite the dust or fumes.
- 3) Keep children and bystanders away while operating a power tool. Distractions can cause you to lose control.

## Electrical safety

- 1) Power tool plugs must match the outlet. Never modify the plug in any way. Do not use any adapter plugs with earthed (grounded) power tools. Unmodified plugs and matching outlets will reduce risk of electric shock.
- 2) Avoid body contact with earthed or grounded surfaces, such as pipes, radiators, ranges and refrigerators. There is an increased risk of electric shock if your body is earthed or grounded.
- 3) Do not expose power tools to rain or wet conditions. Water entering a power tool will increase the risk of electric shock.
- 4) Do not abuse the cord. Never use the cord for carrying, pulling or unplugging the power tool. Keep cord away from heat, oil, sharp edges or moving parts. Damaged or entangled cords increase the risk of electric shock.

- 5) When operating a power tool outdoors, use an extension cord suitable for outdoor use. Use of a cord suitable for outdoor use reduces the risk of electric shock.
- 6) If operating a power tool in a damp location is unavoidable, use a residual current device (RCD with a tripping current of 30 mA or less) protected supply. Use of an RCD reduces the risk of electric shock. NOTE: The term “residual current device (RCD)” may be replaced by the term “ground fault circuit interrupter (GFCI)” or “earth leakage circuit breaker (ELCB)”.

### Personal safety

- 1) Stay alert, watch what you are doing and use common sense when operating a power tool. Do not use a power tool while you are tired or under the influence of drugs, alcohol or medication. A moment of inattention while operating power tools may result in serious personal injury.
- 2) Use personal protective equipment. Always wear eye protection. Protective equipment such as dust mask, non-skid safety shoes, hard hat, or hearing protection used for appropriate conditions will reduce personal injuries.
- 3) Prevent unintentional starting. Ensure the switch is in the off-position before connecting to power source and/or battery pack, picking up or carrying the tool. Carrying power tools with your finger on the switch or energizing power tools that have the switch on invites accidents.
- 4) Remove any adjusting key or wrench before turning the power tool on. A wrench or a key left attached to a rotating part of the power tool may result in personal injury.
- 5) Do not overreach. Keep proper footing and balance at all times. This enables better control of the power tool in unexpected situations.
- 6) Dress properly. Do not wear loose clothing or jewellery. Keep your hair, clothing and gloves away from moving parts. Loose clothes, jewellery or long hair can be caught in moving parts.
- 7) If devices are provided for the connection of dust extraction and collection facilities, ensure these are connected and properly used. Use of dust collection can reduce dust-related hazards.

### Power tool use and care

- 1) Do not force the power tool. Use the correct power tool for your application. The correct power tool will do the job better and safer at the rate for which it was designed.
- 2) Do not use the power tool if the switch does not turn it on and off. Any power tool that cannot be controlled with the switch is dangerous and must be repaired.
- 3) Disconnect the plug from the power source and/or the battery pack from the power tool before making any adjustments, changing accessories, or storing power tools. Such preventive safety measures reduce the risk of starting the power tool accidentally.
- 4) Store idle power tools out of the reach of children and do not allow persons unfamiliar with the power tool or these instructions to operate the power tool. Power tools are dangerous in the hands of untrained users.
- 5) Maintain power tools. Check for misalignment or binding of moving parts, breakage of parts and any other condition that may affect the power tool's operation. If damaged, have the power tool repaired before use. Many accidents are caused by poorly maintained power tools.
- 6) Keep cutting tools sharp and clean. Properly maintained cutting tools with sharp cutting edges are less likely to bind and are easier to control.
- 7) Use the power tool, accessories and tool bits etc. in accordance with these instructions, taking into account the working conditions and the work to be performed. Use of the power tool for operations different from those intended could result in a hazardous situation.

### Service

Have your power tool serviced by a qualified repair person using only identical replacement parts. This will ensure that the safety of the power tool is maintained.

---

## Special safety instructions

- 1) Keep all parts of the body away from the saw chain when the chain saw is operating. Before you start the chain saw, make sure the saw chain is not contacting anything. A moment of inattention while operating chain saws may cause entanglement of your clothing or body with the saw chain.
- 2) Always hold the chain saw with your right hand on the rear handle and your left hand on the front handle. Holding the chain saw with a reversed hand configuration increases the risk of personal injury and should never be done.
- 3) Wear safety glasses and hearing protection. Further protective equipment for head, hands, legs and feet is recommended. Adequate protective clothing will reduce personal injury by flying debris or accidental contact with the saw chain.
- 4) Do not operate a chain saw in a tree. Operation of a chain saw while up in a tree may result in personal injury.
- 5) Always keep proper footing and operate the chain saw only when standing on fixed, secure and level surface. Slippery or unstable surfaces such as ladders may cause a loss of balance or control of the chain saw.
- 6) When cutting a limb that is under tension be alert for spring back. When the tension in the wood fibres is released the spring loaded limb may strike the operator and/or throw the chain saw out of control.
- 7) Use extreme caution when cutting brush and saplings. The slender material may catch the saw chain and be whipped toward you or pull you off balance.
- 8) Carry the chain saw by the front handle with the chain saw switched off and away from your body. When transporting or storing the chain saw always fit the guide bar cover. Proper handling of the chain saw will reduce the likelihood of accidental contact with the moving saw chain.
- 9) Follow instructions for lubricating, chain tensioning and changing accessories. Improperly tensioned or lubricated chain may either break or increase the chance for kickback.
- 10) Keep handles dry, clean, and free from oil and grease. Greasy, oily handles are slippery causing loss of control.
- 11) Cut wood only. Do not use chain saw for purposes not intended. For example: do not use chain saw for cutting plastic, masonry or non-wood building materials. Use of the chain saw for operations different than intended could result in a hazardous situation.
- 12) Maintain a firm grip, with thumbs and fingers encircling the chain saw handles, with both hands on the saw and position your body and arm to allow you to resist kickback forces. Kickback forces can be controlled by the operator, if proper precautions are taken. Do not let go of the chain saw.
- 13) Do not overreach and do not cut above shoulder height. This helps prevent unintended tip contact and enables better control of the chain saw in unexpected situations.
- 14) Only use replacement bars and chains specified by the manufacturer. Incorrect replacement bars and chains may cause chain breakage and/or kickback.
- 15) Follow the manufacturer's sharpening and maintenance instructions for the saw chain. Decreasing the depth gauge height can lead to increased kickback.
- 16) Two hands must be used in operation of chain saw.
- 17) Cut the wood in right direction.
- 18) Make sure that the voltage on the rating plate is the same as your supply system. Only then are you to insert the power plug in the mains socket outlet.
- 19) Wear eye protection, ear protection and gloves.
- 20) Before using the chain saw, be sure to check the chain and bar in tension. Don't use the chain saw if the chain and bar are loose. Also confirm that no abnormality exists by actual test running.

- 21) Contact of guide bar tip with any object should be avoided. Tip contact may cause the guide bar to suddenly move upward or backwards which may cause serious injury to user.
- 22) Do not operate in rain.
- 23) Disconnect the saw from power supply when not in use, and before performing maintenance or adjustments.
- 24) Pull out the power plug before you change or adjust the bar and chain. Use only suitable bar Oregon 160SEDA074 and chain Oregon 91PJ056X.
- 25) Never leave the machine unattended in rooms with children.
- 26) Keep the machine out of children's reach.
- 27) The first-time user should, as a minimum practice, cut logs on a saw-horse or cradle.

## Description of machine parts

1. Rear handle
2. Safety lock-off button
3. Trigger
4. Oil filler cap
5. Chain bar
6. Chain
7. Front handle
8. Motor and air slots
9. Electric power lead
10. Chain cover with safety chain brake trigger
11. Chain tension knob
12. Side cover
13. Clamp knob
14. Small end of chain tension lever
15. Locking pin
16. Sprocket

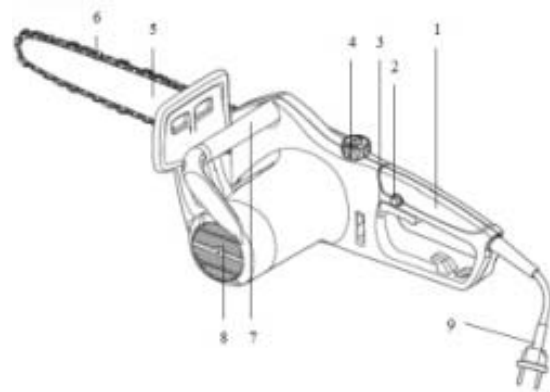

**Fig. 1**

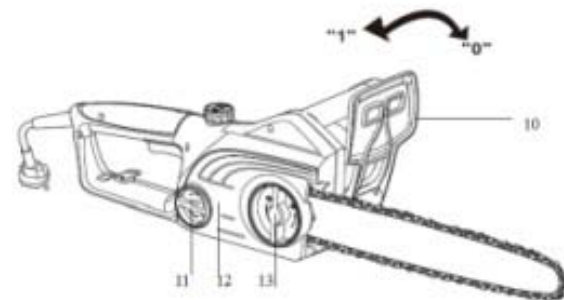

**Fig. 2**

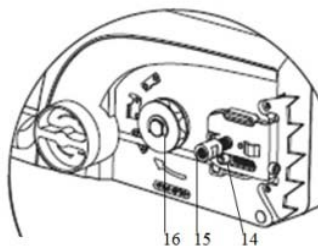
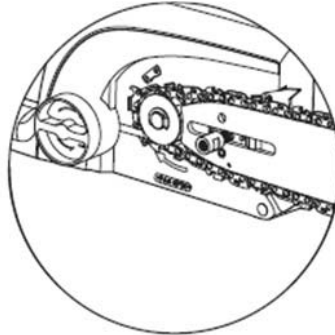

**Fig. 3**

## Bar and chain assembly (Fig. 1-4)

- 1) Check that the chain brake (10) is not active, brake trigger in position "1".
- 2) Remove the side cover (12) and the clamp knob (13).
- 3) Put the chain bar (5) on the locking pin (15) and push it to the sprocket (16).
- 4) Put the chain (6) on the bar, beginning from the top, ensure cutter teeth are facing direction of chain rotation.
- 5) Ensure chain fits around sprocket (16) and check that small end of chain tension level (14) fits into bottom hole of bar.
- 6) Position the chain side cover (12) and clamp the knob (13) finger tight.

- 7) Adjust chain tension knob (11) on “+” direction so that when lifting the chain and entire drive link is just visible. Ensure chain rotates smoothly on bar, fully tighten knob.
- 8) Do not over tense the chain as this will reduce life of chain bar and motor.
- 9) Do not under tense the chain as this will make it fall down while working.



**Fig. 4**

## Safety chain brake

- 1) This area (see picture below) shows the parts of chainsaw most likely to cause kickback.
- 2) In the event of kickback, the left hand will come into contact with chain brake lever, that incorporates a separate electrical switch to cut out the current to the motor, stopping the chain immediately (“0” position ).
- 3) To rest after operation of the chain brake, disconnect from power supply and release the brake by pulling the brake lever into the rearward position (“1” position).
- 4) Check chain tension before restarting.

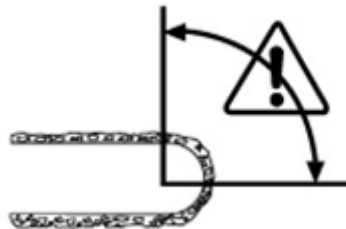

## Switching On/Off

### Switching ON

Have a firm grip on the handles. To operate, ensure both the trigger (3) and the safety lock-off (2) on the side are depressed simultaneously.

### Switching OFF

To stop the chain saw, release the trigger (3).

## Electric motor safety system

This chain saw has a device that protects the motor by disconnecting it when the effort is too high. To restart, release the trigger (3), check that the chain is able to rotate and push the trigger (3) and lock-off button (2) to start again.

## Maintenance

The following suggestions deal with the daily maintenance of the chain saw. If they could not be exhaustive, contact an authorised service centre.

If the replacement of the supply cord is necessary, this has to be done by the manufacturer or his agent in order to avoid a safety hazard.

- 1) Ensure that the electric power lead (9) is not damaged.
- 2) Ensure that the motor and air slots (8) are free and unobstructed.
- 3) Check that the lubrication system is adequate.
- 4) Clean the chain brake and ensure that it works properly.
- 5) Turn the bar over every day.
- 6) Check the bar wear.
- 7) Ensure that the oil flow hole is unobstructed.
- 8) Clean the chain guide on the bar.
- 9) Check the chain tension, sharpen the blades and check their conditions, eventually removing irregularities.
- 10) Check the guide bar sprocket condition.
- 11) Ensure that the oil reservoir and the oil filter are clean.

This chain saw meets all current legislation requirements, in order to avoid injuries while repairing; every repairing has to be done by qualified staff in an authorized service centre.

## Chain sharpening

- 1) Disconnect the cord from the mains supply.
- 2) Wear protective gloves.
- 3) Ensure the chain is correctly tensioned and not too loose.
- 4) Engage the chain brake (10) to block the chain on the bar when sharpening ("0").
- 5) Use a round file for chain sharpening, diameter equivalent to 1,1 times the cutting tooth depth.
- 6) File at a horizontal angle, 35° to the bar.
- 7) File from inside towards outside of the tooth only.
- 8) Sharpen each tooth equally by using the same number of strokes.
- 9) File at an angle of 90° to the bar.
- 10) Check the safety depth gauge height every 5 chain sharpening. Use depth gauge measuring instrument to check the height of the depth gauge.

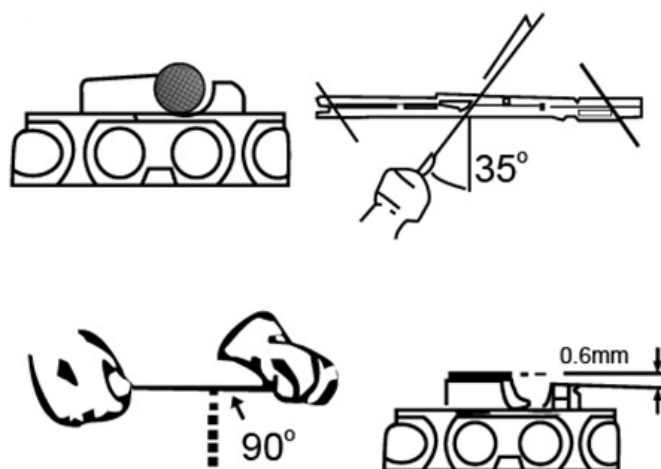



## General suggestions for cutting

We suggest that you should cut utilizing the bottom of the bar; this way of operating diminishes the probability of injuring. Be careful when cutting with the top of the bar.

### Cutting logs

#### Cutting a log resting on the two extremities

First cut 1/3 of a diameter from the top.

Next cut from below using the top of the bar, this will avoid pinching of the bar in wood. Avoid touching the ground with the bar.

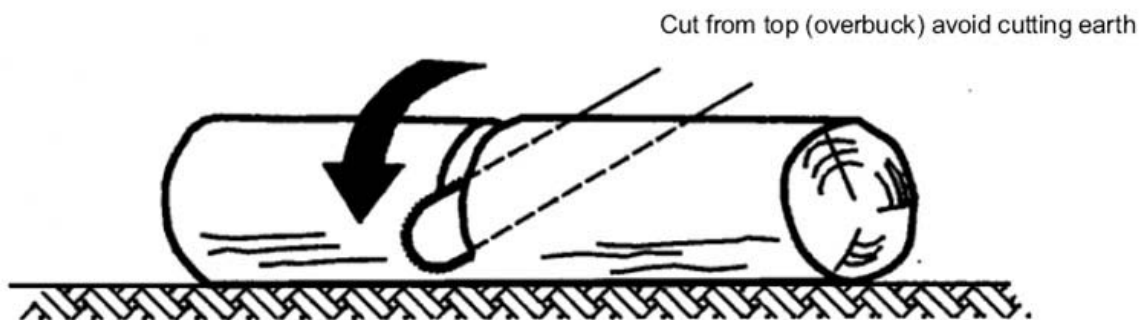
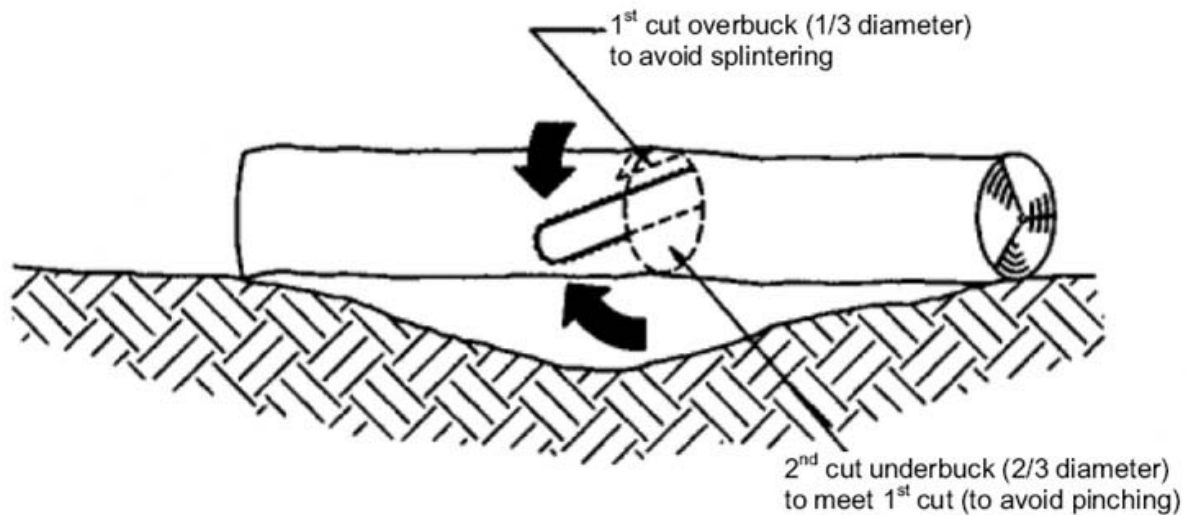

#### Cutting from a saw horse

First cut 1/3 of a diameter from the below.

Next cut from the top using the bottom of the bar.

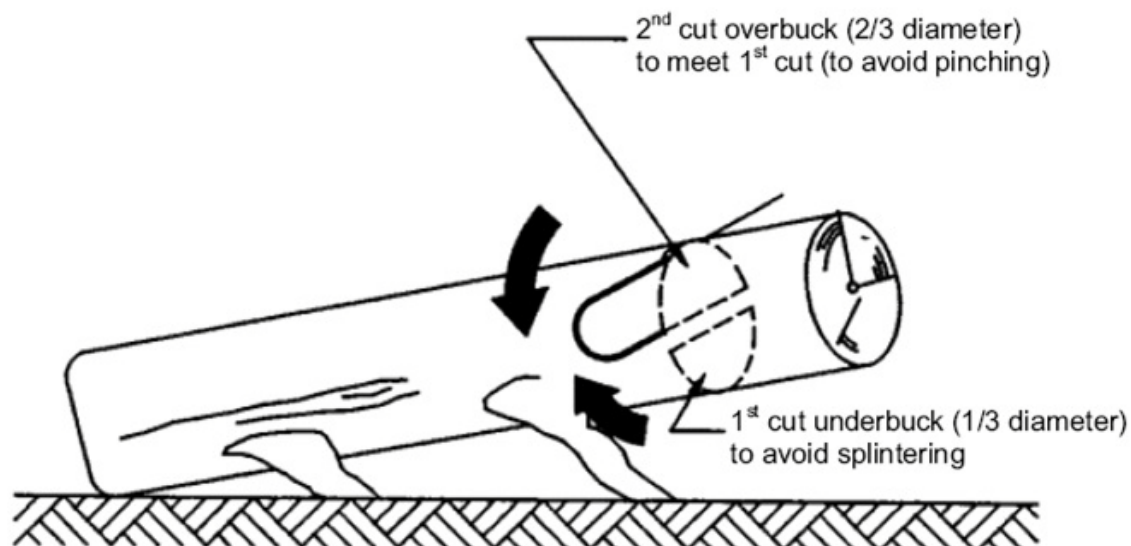

## Felling a tree

Before felling a tree, consider carefully all conditions including the intended direction of the fall, the natural lean of the tree, surrounding trees and obstacles, the wind direction and speed.

### Directional cut

Cut a wedge (1/3-1/2 of tree diameter) out of the trunk on the side which you want the tree to fall.

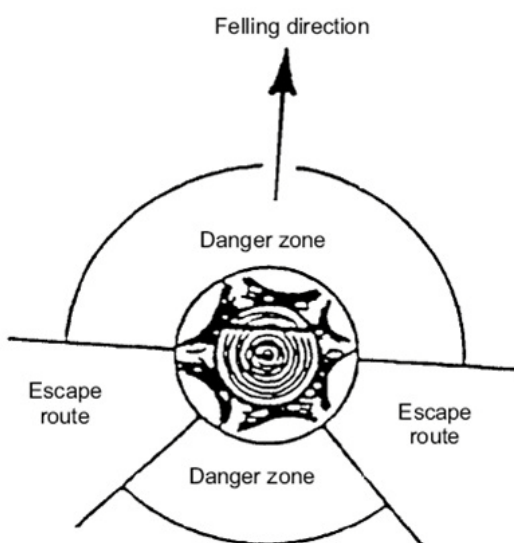

### Felling cut

Cut into the trunk from the other side 3-6 cm above the wedge.

Use a felling wedge to help control felling and prevent binding the guide bar and saw chain in the cut.

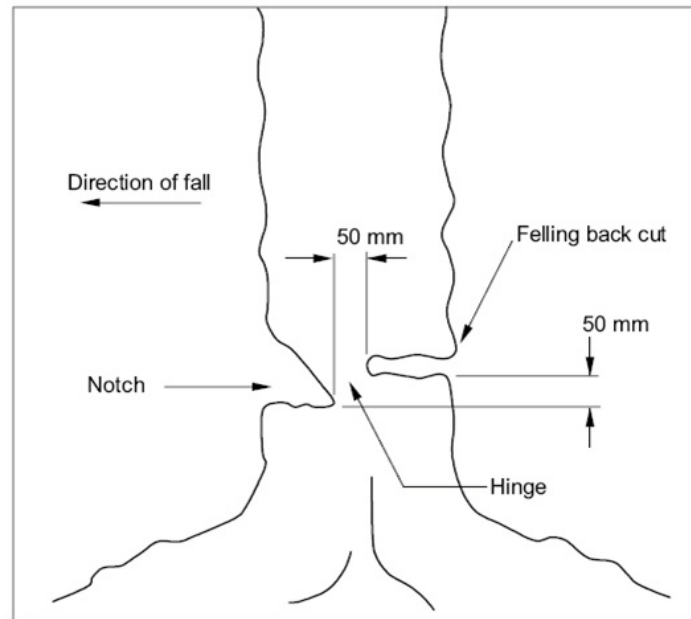

### How to cut the ramification and log

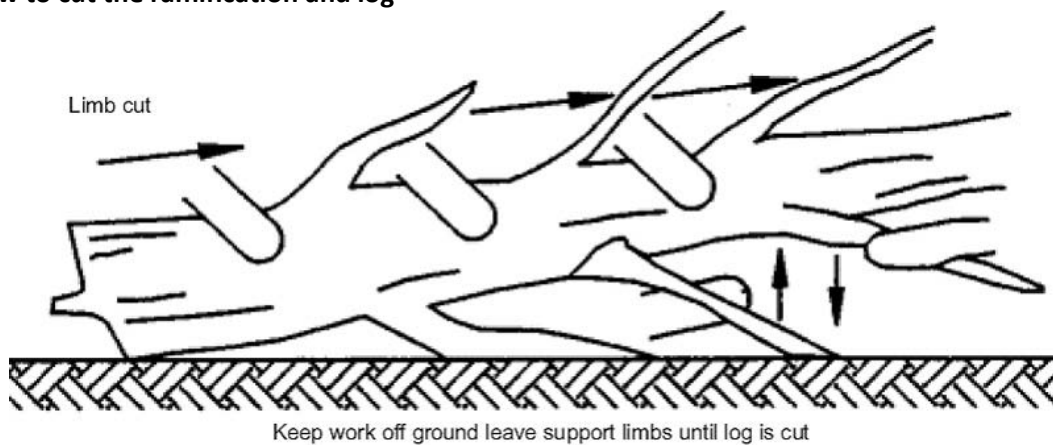

## Specifications

Model	VARI 2300 W (GT5221/SCS723A)
Nominal voltage	230 V ~ 50 Hz
Power	2300 W
Electric engine no load speed	5600 min <sup>-1</sup>
Chain speed	13 m/s
Bar length	16" (40 cm)
Chain pitch	9,525 mm
Chain gauge	1,27 mm
Sprocket	7 x 9,525
Insulation class	Class II
Net weight	4,7 kg
Type of saw chain	Oregon 91PJ056X
Type of guide bar	Oregon 160SDEA074

## Declared noise and vibrations values

Declared emission level of acoustic pressure A at operator's site  $L_{pAd}$  (according to CSN EN ISO 22868 Appendix B and CSN EN ISO 11201): 93 <sup>3,0</sup> dB

Guaranteed level of acoustic performance of the machine  $L_{WA}$  (according to Decree of the Government No. 9/2002 Gaz. Appendix No. 3, Part B, Point 25 and CSN ISO 3744): 110 dB

Declared aggregate value of accelerated vibrations transmitted onto operator's hands/arms  $a_{hvd}$  (according to CSN EN ISO 22867 and CSN EN ISO 20643): 6,5 <sup>1,5</sup> m/s<sup>2</sup>

With respect to the fact that the declared levels of acoustic pressure A at operator's site exceed the value of 85 dB, it is necessary to use personal noise protective aids.

With respect to the exceeded recommended values of noise and vibrations, you are warned to observe the following instructions when working with the machine:

- Protect your hearing by using suitable protective aids specified in CSN EN 352-1 (shell ear protectors) or CSN EN 352-2 (plug ear protectors). Require the aids from your dealer.
- Working with the machine should be interrupted after max. 20 minutes for a minimum break of 10 minutes. During these breaks, the machine operator must not be exposed to the impact of another source of noise or vibrations.
- Machine operators should use working aids authorized to CSN EN 166 or CSN EN 1731 (tight-fitting garments, sturdy shoes, working gloves and protection glasses).

### Guaranteed level of acoustic performance $L_{WA}$ = 110 dB

The electric chain saw VARI 2300 W is manufactured by SUMEC Hardware & Tools Co., Ltd., 1# Xinghuo Road, National Level Nanjing High-Tech Zone, Nanjing, 210061, P. R. China.

Importer to EU and distributor: VARI, a.s., Opolanska 350, 289 07 Libice nad Cidlinou, Czech Republic.

## Disposal of packaging and machine after the end of service life

After unpacking the machine, you are obliged to provide for the disposal of packaging material with taking into account the use of secondary raw materials according to national waste laws and regulations.

The following procedure is recommended for machine disposal after the end of its service life:

1. Dismount all parts from the machine that can still be used.
2. Dismount plastic machine parts and parts made of non-ferrous metals. The dismantled machine remainder and the dismantled parts are to be disposed according to national waste laws and regulations and with respect to the decrees of local town or municipal authorities.
3. Regarding waste from the electrical device, use the opportunity of return buy-out in the shop, where you purchased the device (points 1 and 2 are not valid in this case).
4. The machine is in accordance with the RoHS Directive (2002/95/ES, 2002/96/ES, 2003/108/ES).
5. The product is in accordance with the requirements of the above-mentioned EC Directive regarding the quantities of forbidden dangerous substances.



**This pictograph means that the product was introduced on the market after 13th September 2005 and shall not be disposed to a waste container or a dustbin.**

## Instructions for ordering spare parts

The following data are to be used for an easier identification when ordering the spare parts:

1. Machine type, engine type, machine serial number and year of manufacture;
2. Ordering number given by manufacturer and its name in the part list;
3. Number of ordered pieces separately for each item;
4. Precise address, telephone number, fax number or e-mail address;
5. Should you be uncertain about the correct identification of the component, send the damaged component either to the nearest service shop;
6. All components should be ordered in the nearest service shop or at your dealer's.

In the case of any confusion concerning the spare parts or technical issues, the commercial or customer-service departments are prepared to answer all your inquiries.

## Address of the seller

VARI, a.s.	phone:	(+420) 325 607 111
Opolanska 350	fax:	(+420) 325 607 264
289 07 Libice nad Cidlinou	e-mail:	<a href="mailto:vari@vari.cz">vari@vari.cz</a>
CZECH REPUBLIC		

## Spare part list

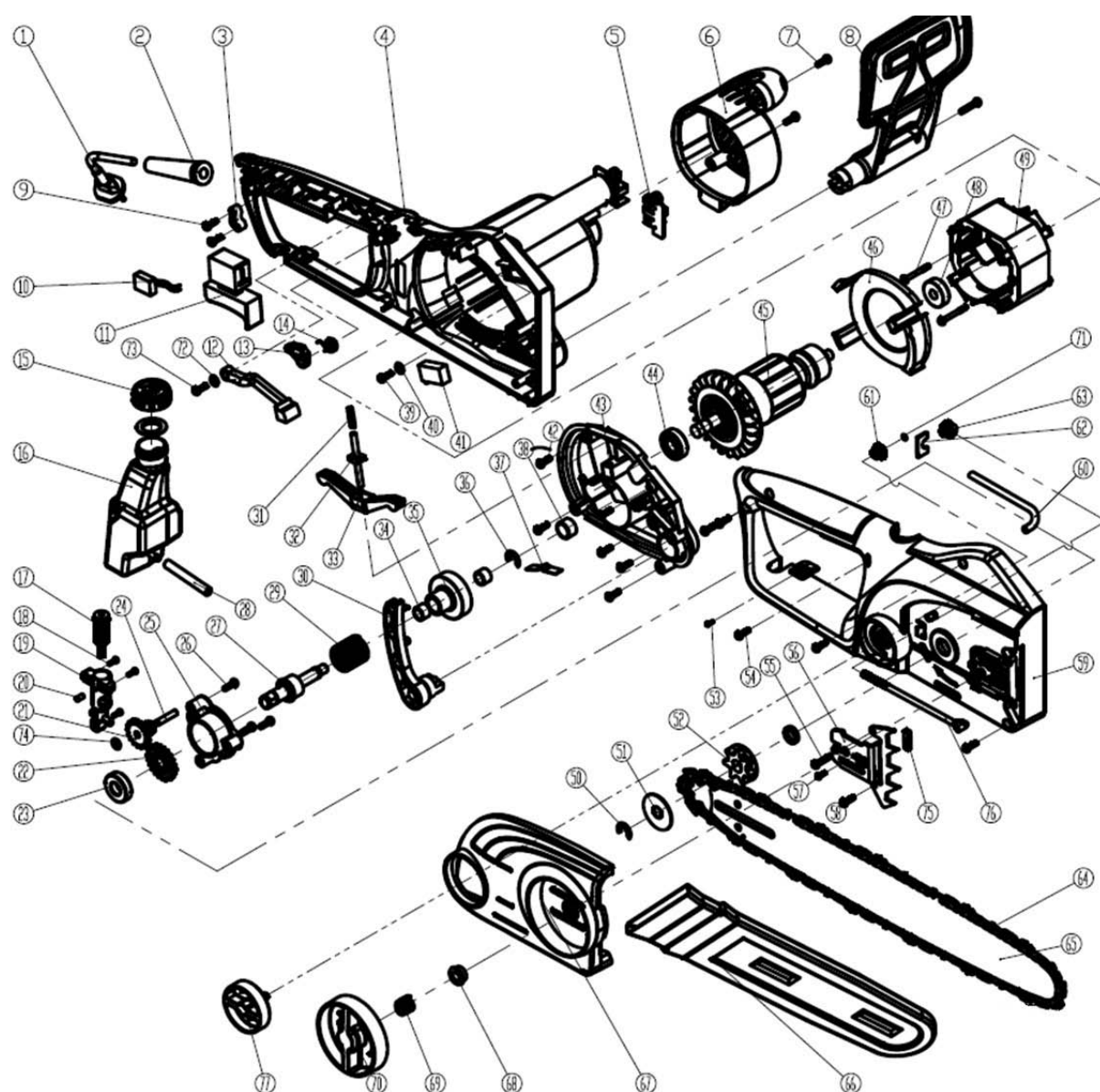



Pos.	Part No.	Name	Pcs	Pos.	Part No.	Name	Pcs
1	410703	power cord	1	40	411831	washer	1
2	419016	power cord protector	1	41	410705	micro switch	1
3	401705	cord restrainer	1	42	B400025F	screw ST4.2x16	6
4	452001	left housing	1	43	452007	medium cover	1
5	452702	motor carbon brush	2	44	104605	bearing 6001RS	1
6	452003	rear cover	1	45	452703	motor armature	1
7	B400025F	screw ST4.2x16	3	46	452017	air-flow shroud	1
8	452010	hand guard	1	47	B400033F	screw ST4.2x60	2
9	B400025F	screw ST4.2x16	2	48	409602	bearing 6000RZ	1
10	408905	capacitor	1	49	452701	motor stator	1
11	410703	switch	1	50	452806	shield ring	1
12	452009	rear rocker	1	51	452201	washer	1
13	452004	lever	1	52	452401	sprocket	1
14	452501	spring	1	53	408814	screw st2.9x13	1
15	452015	cover	1	54	B400025F	screw ST4.2x16	5
16	452016	oil tank	1	55	402811	screw ST4.2x25	1
17	452014	pump shaft	1	56	452203	buffer	1
18	B400006F	screw ST2.9x13	3	57	411822	screw ST3.5x10	1
19	452013	pump	1	58	B400025F	screw st4.2x16	1
20	452202	pin	1	59	452032	right housing	1
21	452012	pump gear	1	60	452303	oil tube	1
22	452402	gear	1	61	452406	gear 1	1
23	104605	bearing 6001RS	1	62	452218	support	1
24	452212	pin	1	63	452405	gear 2	1
25	452011	gear cover	1	64		chain	1
26	B400025F	screw ST4.2x16	3	65		chain bar	1
27	452206	shaft	1	66	410017	chain protector	1
28	452305	oil tube	1	67	452033	cover panel	1
29	452506	spring	1	68	452404	bush	1
30	452009	front rocker	1	69	452508	spring	1
31	452502	spring	1	70	452031	knob	1
32	452008	brake shaft	1	71	452220	lock ring	1
33	452006	teeterboard	1	72	411831	washer	1
34	452803	bearing HK1010	2	73	402810A	screw ST4.2x13	1
35	442205	gear	1	74	452804	washer	1
36	452805	shield ring	1	75	452219	rubber ring	1
37	452503	spring	1	76	452217	screw	1
38	452802	bearing HK0810	1	77	452035	knob	1
39	B400012F	screw ST3.5x10	1				

## Declaration of conformity

### EC declaration of conformity according to Act No. 22/1997 Gaz. (as amended)

#### 1) Importer:

**VARI, a.s., Opolanska 350, 289 07 Libice nad Cidlinou, Czech Republic**

Reg. No.: 00660574, VAT No.: CZ00660574. Registered in the Company Register at MS Praha, Section B, Insert 499

issue the following statement at their own responsibility.

#### 2) Description of the machine/equipment:

Trade mark	Name	Type	Serial numbers
VARI	Electric chain saw	VARI 2300 W	00000001-99999999
Input	2300 W / 230 V	Weight	4,7 kg
Frequency	50 Hz	Bar length	40 cm

Electric chain saw VARI 2300 W is equipped with a strong engine with an input of 2300 W. This chain saw has a bar with a length of 40 cm. Thanks to its low weight, the chain saw 2300 W is a perfect helper for removal of shrubbery, felling of smaller trees and splitting of wood material.

#### 3) Regulations according to which the conformity was assessed:

NV No. 9/2002 Gaz. (2000/14/EC)

(see page 2 of this statement)

NV No. 17/2003 Gaz. (2006/95/EC)

NV No. 616/2006 Gaz. (2004/108/EEC)

NV No. 176/2008 Gaz. (2006/42/EC)

(all Decrees of the Government (NV) and directives as amended)

#### 4) Notified person participating in the compliance assessment:

a) Name: -

b) Seat: -

c) AO: - , NB No.: - , Accredited test laboratory No.: -

d) Certificate, Final report: -

#### 5) Harmonized technical standards, national technical standards and technical specifications applied:

EN 55014-1:2006, EN55014-2/A1:2001, EN61000-3-2:2006, EN61000-3-3/A2:2005, EN61000-3-11:2000, EN60335-1/A13:2008, EN60335-2-77:2006, EN62233:2008, EN836:1997+A1:1997+A2:2001+A3:2004, EN ISO 3744:1995, ISO 11094:1991, EN ISO 14121-1:2007

#### 6) Last two digits of the year when the product was marked with CE: 07

#### 7) Technical documentation file No. in which the product compliance with the regulations is assessed:

**STD/008/2010**

Place of issue of the declaration of conformity: Libice nad Cidlinou

Date: 13.4.2010

Name, surname and function of the person authorized to sign this EC declaration of conformity:

Jiří BELINGER, Director General and Chairman of the Board of Directors, VARI, a.s.

Signature:



Stamp:

**VARI** - Konstrukce  
Opolanská 350  
289 07 Libice nad Cidlinou  
DIČ: CZ00660574



# EC declaration of conformity according to Act No. 22/1997 Gaz. (as amended)

**1) Importer:**

**VARI, a.s., Opolanska 350, 289 07 Libice nad Cidlinou, Czech Republic**

Reg. No.: 00660574, VAT No.: CZ00660574. Registered in the Company Register at MS Praha, Section B, Insert 499

**2) Technical documentation is archived at:** See Item 1.

**3) Description of the machine/equipment:**

Trade mark	Name	Type	Serial numbers
VARI	Electric chain saw	VARI 2300 W	00000001-99999999
Input	2300 W / 230 V	Weight	4,7 kg
Frequency	50 Hz	Bar length	40 cm

**4) Procedure used to assess the compliance:**

NV No. 9/2002 Gaz. §5 paragraph 1 letter a), annexe No. 5 to NV No. 9/2002 Gaz.

**5) Authorized person participating in the compliance assessment:**

Intertek Testing Services Shanghai, Building No. 86, 1198 Qinzhou Road (North), Shanghai 200233, P. R. China

Test reports: JSH007040327-001+A1+A2+A3+A4, JSH007040328-001, JSH007040329-001

**6) Notified person which issued the certificates:**

Intertek Testing Services Shanghai, Building No. 86, 1198 Qinzhou Road (North), Shanghai 200233, P. R. China

Certificates: SH09100676-V1, V007040328-1

Intertek Deutschland GmbH, Max-Eyth-Str. 14, 70771 Leinfelden-Echterdingen, Germany

Certificates: 07SHW2020-07

**7) Noise levels:**

Measured	Guaranteed
$L_{WA} = 107 \text{ dB/1pW}$	$L_{WA} = 110 \text{ dB/1pW}$

**8) Reference to the Decree of the Government (NV):**

NV No. 9/2002 Gaz. (as amended).

Note: This Decree of the Government complies with the European Parliament and Council Directive 2000/14/EC of 8 May 2000 on the alignment of member countries legislations concerning noise emissions from the machinery used in outdoor space.

**9) Declaration of the compliance with the requirements:**

We declare that the above mentioned machine/equipment complies with the requirements of the Decree of the Government No. 9/2002 Gaz. (as amended).

**10) Other EC declarations of conformity issued to this machine/equipment:**

NV No. 616/2006 Gaz. (2004/108/EEC), NV No. 176/2008 Gaz. (2006/42/EC), NV No. 17/2003 Gaz. (2006/95/EC)

(all Decrees of the Government (NV) and directives as amended)

**11) Person charged with filing of the technical documentation:**

Lukas Svoboda, Opolanska 350, Libice nad Cidlinou, 289 07, Czech Republic

**Place of issue of the declaration of conformity:** Libice nad Cidlinou

**Date:** 13.4.2010

**Name, surname and function of the person authorized to sign this EC declaration of conformity:**

Jiří BELINGER, Director General and Chairman of the Board of Directors, VARI, a.s.

Signature:



Stamp:

**VARI** - Konstrukce  
Opolanska 350  
289 07 Libice nad Cidlinou  
DIČ: CZ00660574

## Letter of guarantee

### To be completed by the importer

Product name                      Electric chain saw  
 Model                                VARI 2300 W  
 Serial number                    .....  
 Engine serial number           .....  
 Warranty (months)               ..... 24 .....  
 Output control                    .....

The above product was passed over to the purchaser without any defects including the appropriate commercial and technical documentation and accessories. The purchaser was duly informed about the principles of proper operation and technical maintenance of the product.

### To be completed by the seller

Purchaser's name                    .....  
 Purchaser's address                .....  
 Purchaser's signature               .....  
 Place of sale                          .....  
 Date of sale                            .....

Stamp and signature of the seller                    .....

### GUARANTEE CONDITIONS

#### Subject of warranty:

Warranty relates to the basic product including accessories supplied by VARI, a.s.

#### Warranty period:

Warranty period for the product and accessories supplied with the product is 24 months from the date of sale to the purchaser. Time from the enforcement of liability for defects to the date when the user was obliged to take over the thing after the end of repair is not included in the warranty period.

The seller is obliged to give the purchaser a receipt confirming the date of the right exercise and repair and the time of its duration. If the product is exchanged, the warranty period starts running again from the date on which the purchaser took over the new product. If it is a whole assembly to be replaced, the warranty period starts running for the given assembly again from the date of product take-over.

#### Scope of importer's liability:

The importer bears responsibility for the product having properties usual for the kind of the product in question and specified parameters for the whole period of warranty. The importer does not answer for defects of the product resulting from current wear or from the product's use for purposes other than specified.

#### Warranty extinction:

##### Claim of warranty extinct if:

- the product was not used and maintained as specified in the Instruction manual, or it was damaged by any unauthorized operation by the user;
- the product was used in conditions or for purposes other than specified;
- the letter of guarantee for the product cannot be presented;
- data filled in the original product's documentation by the manufacturer, seller or service organization were intentionally falsified;
- a part of the product was replaced with a non-original component;
- the product was damaged or excessively worn due to improper maintenance;
- the product suffered an accident or was damaged by an Act of God;
- a modification was made to the product made without manufacturer's consent;
- defects result from improper storage of the product;
- defects result from natural and common operating wear of the product;
- the product was connected to or operated with the equipment not approved by the importer.

#### Complaints:

Complaints are applicable by purchasers at the seller's. When applying a complaint, the purchaser is obliged to submit a duly filled in letter of guarantee. Warranty repairs are carried out by sellers or by special service shops appointed by them.

#### Legislation:

Other purchaser/seller relations follow appropriate provisions of the legal regulations according to national legislation in the country of sale.

<b>Warranty inspection 1</b> Date: .....Person in charge: ..... Service shop stamp and signature	<b>Warranty inspection 1</b> Machine model: ..... Serial No.: .....
<b>Warranty inspection 2</b> Date: .....Person in charge: ..... Service shop stamp and signature	<b>Warranty inspection 2</b> Machine model: ..... Serial No.: .....
<b>Warranty service 1</b> Date of complaint delivery:..... Date of repair:..... Brief description of the defect:..... ..... ..... Replaced parts (new warranty of ... months): ..... Parts: ..... ..... Repair made by: ..... ..... Service shop stamp and signature	<b>Warranty service 1</b> Machine model..... Serial No.: ..... Date: ..... Repair made by: ..... ..... ..... Stamp and signature..... ..... .....
<b>Warranty service 2</b> Date of complaint delivery:..... Date of repair:..... Brief description of the defect:..... ..... ..... Replaced parts (new warranty of ... months): ..... Parts: ..... ..... Repair made by: ..... ..... Service shop stamp and signature	<b>Warranty service 2</b> Machine model..... Serial No.: ..... Date: ..... Repair made by: ..... ..... ..... Stamp and signature..... ..... .....
<b>Warranty service 3</b> Date of complaint delivery:..... Date of repair:..... Brief description of the defect:..... ..... ..... Replaced parts (new warranty of ... months): ..... Parts: ..... ..... Repair made by: ..... ..... Service shop stamp and signature	<b>Warranty service 3</b> Machine model..... Serial No.: ..... Date: ..... Repair made by: ..... ..... ..... Stamp and signature..... ..... .....
<b>Warranty service 4</b> Date of complaint delivery:..... Date of repair:..... Brief description of the defect:..... ..... ..... Replaced parts (new warranty of ... months): ..... Parts: ..... ..... Repair made by: ..... ..... Service shop stamp and signature	<b>Warranty service 4</b> Machine model..... Serial No.: ..... Date: ..... Repair made by: ..... ..... ..... Stamp and signature..... ..... .....